

Restrictions for stowed or covered appliances

This document provides guidance for the safety requirements of 'clause 6.3.2 Restriction of stowed appliances of AS/NZS 5601.2:2020' and how it applies to gas cooking appliances installed to external slide out kitchens in caravans and camper trailers (recreational vehicles).

Interpretation of clause 6.3.2

- Where the gas supply to an appliance is disconnected, for example gas cannot flow when the appliance is stowed away, the requirements of this clause have been satisfied.
- The term stowed means storing, positioning or covering an appliance for travelling.
- The note referencing aftermarket lid or cover relates to a cooking appliance within a vehicle that can be covered by a lift-out or hinged workbench or cover while still connected to the gas supply, requiring a form of interlock (refer figure 1) to satisfy the means of compliance within clause 6.3.2.

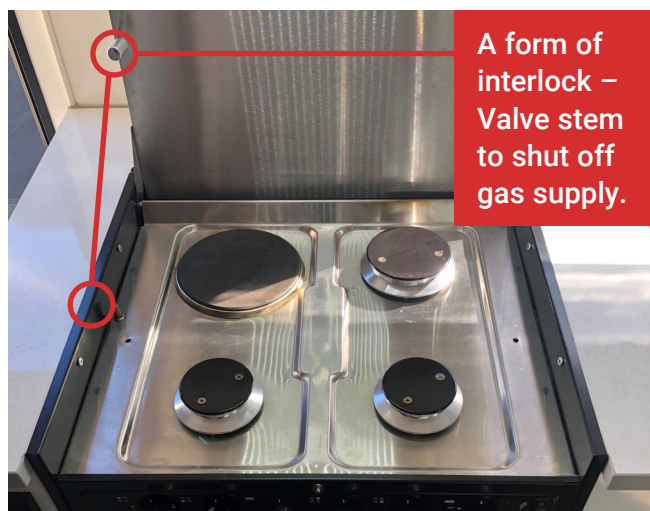

Figure 1 – A typical acceptable 'form of interlock'.

Applying clause 6.3.2 to external slide out kitchens

1. Where the gas supply to the appliance must either be disconnected (via a bayonet connection to allow the slide out kitchen to be retracted to within the body of the vehicle) or fitted with an appropriate device to ensure that gas cannot flow to that appliance in its stowed position, the means of compliance within clause 6.3.2 have been satisfied. Please refer examples of such slide out kitchens shown in figures 2, 3, 4 and 5.
2. The provision of any non-combustible (such as stainless-steel) wind shield or fold-out kitchen bench extension is not considered to be a lid or cover in the context of the note to clause 6.3.2. The appliance (cooktop) is not considered to be stowed until it is retracted to within the body of the vehicle for travel. Thereby, not requiring a means of gas isolation for such installations. However, appropriate permanent and durable labels should be provided for warning hot surfaces.

Building and Energy gratefully acknowledges the assistance of [Resources Safety and Health Queensland](#) in developing this fact sheet.



Figure 2 – Example of slide out kitchen.



Figure 4 – Example of slide out cooker.



Figure 3 - Example of slide out kitchen.



Figure 5 – Example of a cooker in its stowed position.

**Department of Local Government,
Industry Regulation and Safety**
www.lgirs.wa.gov.au

Regional Offices:

Goldfields/Esperance	(08) 9021 9494
Great Southern	(08) 9842 8366
Kimberley	(08) 9191 8400
Mid West	(08) 9920 9800
North West	(08) 9185 0900
South West	(08) 9722 2888

Building and Energy Division

Level 1 Mason Bird Building
303 Sevenoaks Street
(entrance Grose Avenue)
Cannington Western Australia 6107
Locked Bag 14, Cloisters Square
Perth WA 6850

Call: 1300 489 099

Email: be.info@lgirs.wa.gov.au

www.lgirs.wa.gov.au/building-and-energy

Disclaimer: The information contained in this fact sheet is provided as general information and a guide only. It should not be relied upon as legal advice or as an accurate statement of the relevant legislation provisions. If you are uncertain as to your legal obligations, you should obtain independent legal advice.

This publication is available in other formats on request.

National Relay Service: 13 36 77

Translating and Interpreting Service (TIS): 13 14 50