

**NOTIFICATION OF PROPOSED AGREEMENT UNDER
SECTION 47C NATIVE TITLE ACT 1993 (CTH)**

LOT 13 ON DP 91083 (RESERVE 34606 – GIBSON DESERT NATURE RESERVE)

NOTICE is given that, three months after the date of this notice, the State of Western Australia proposes to make an agreement for the purposes of section 47C (1)(b) of the *Native Title Act 1993* (Cth) (**NTA**) in relation to Lot 13 on Deposited Plan 91083 (Reserve 34606 – Gibson Desert Nature Reserve) that has a total area of approximately 1,824,864 hectares, excluding road corridors (Agreement Area).

The effect of the agreement would be to require the Federal Court of Australia, when determining the native title determination application to be made on behalf of the Gibson Desert People in relation to the Agreement Area, to disregard any prior extinguishment of native title by the creation of any prior interest and public works.

In accordance with section 47C (6) of the *NTA*, interested persons may, within three months of the date of this notice, comment on the proposed agreement. Comments should be in writing and sent to: -

*Aboriginal Engagement Directorate
Level 4, Dumas House
2 Havelock Street
WEST PERTH WA 6005*

For further information please contact Mr Simon Moore, Advisor Legal and Policy, Aboriginal Engagement Directorate by email at simon.moore@dpc.wa.gov.au or by telephone on (08) 6552 5475.

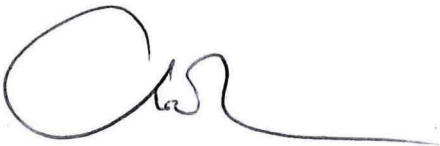

Hon Stephen Dawson MLC
MINISTER FOR ABORIGINAL AFFAIRS
29 MAR 2021

GIBSON DESERT NATURE RESERVE NATIVE TITLE COMPENSATION SETTLEMENT AGREEMENT

MAP 1

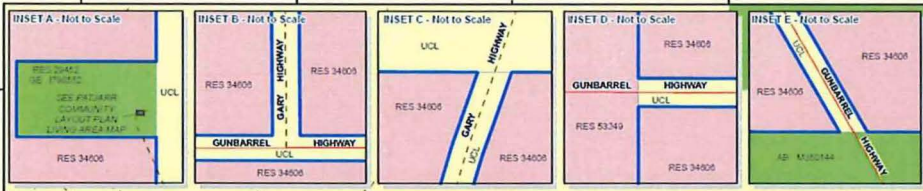
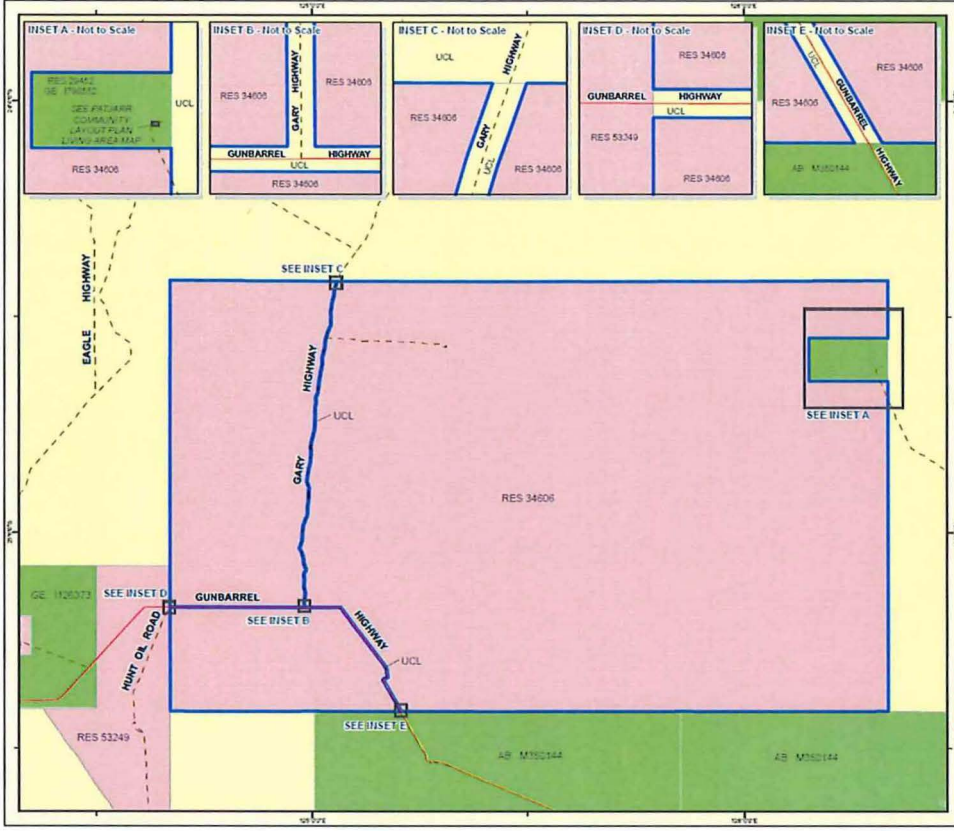

LEGEND

- State Forest
- Marine Park
- Miscellaneous Tenures
- Unallocated Crown Land
- Freehold
- Pastoral Leases
- General and Special Purpose Leases
- Perpetual and Conditional Purchase Leases
- Reversion
- Moor Road
- Track
- Agreement Area



DISCLAIMER
 This map is a representation of the information available to the State of Queensland as at the date of publication. It is not intended to be a substitute for a title search or other legal advice. The State of Queensland does not warrant the accuracy or completeness of the information shown on this map. The State of Queensland is not responsible for any loss or damage arising from the use of this map. The State of Queensland is not responsible for any loss or damage arising from the use of this map. The State of Queensland is not responsible for any loss or damage arising from the use of this map.



DISCLAIMER
 This map is a representation of the information available to the State of Queensland as at the date of publication. It is not intended to be a substitute for a title search or other legal advice. The State of Queensland does not warrant the accuracy or completeness of the information shown on this map. The State of Queensland is not responsible for any loss or damage arising from the use of this map. The State of Queensland is not responsible for any loss or damage arising from the use of this map. The State of Queensland is not responsible for any loss or damage arising from the use of this map.

GRAPHIC SERVICES
 Prepared by:
 State of Queensland
 Department of Natural Resources and Environment
 Brisbane
 Queensland
 Australia