

This structure plan is prepared under the provisions of the Shire of Augusta Margaret River Local Planning Scheme No. 1.

IT IS CERTIFIED THAT THIS STRUCTURE PLAN WAS APPROVED BY RESOLUTION OF THE WESTERN AUSTRALIAN PLANNING COMMISSION ON:

9 July 2009

In accordance with Schedule 2, Part 4, Clause 28 (2) and refer to Part 1, 2. (b) of the *Planning and Development (Local Planning Schemes) Regulations 2015*.

Date of Expiry: 19 October 2025

Amendment No.	Amendment summary	WAPC endorsed date
1	This amendment moved the building envelope on Lot 4, eastward away from Caves Road to improve amenity and to avoid vegetation removal.	09-May-2019

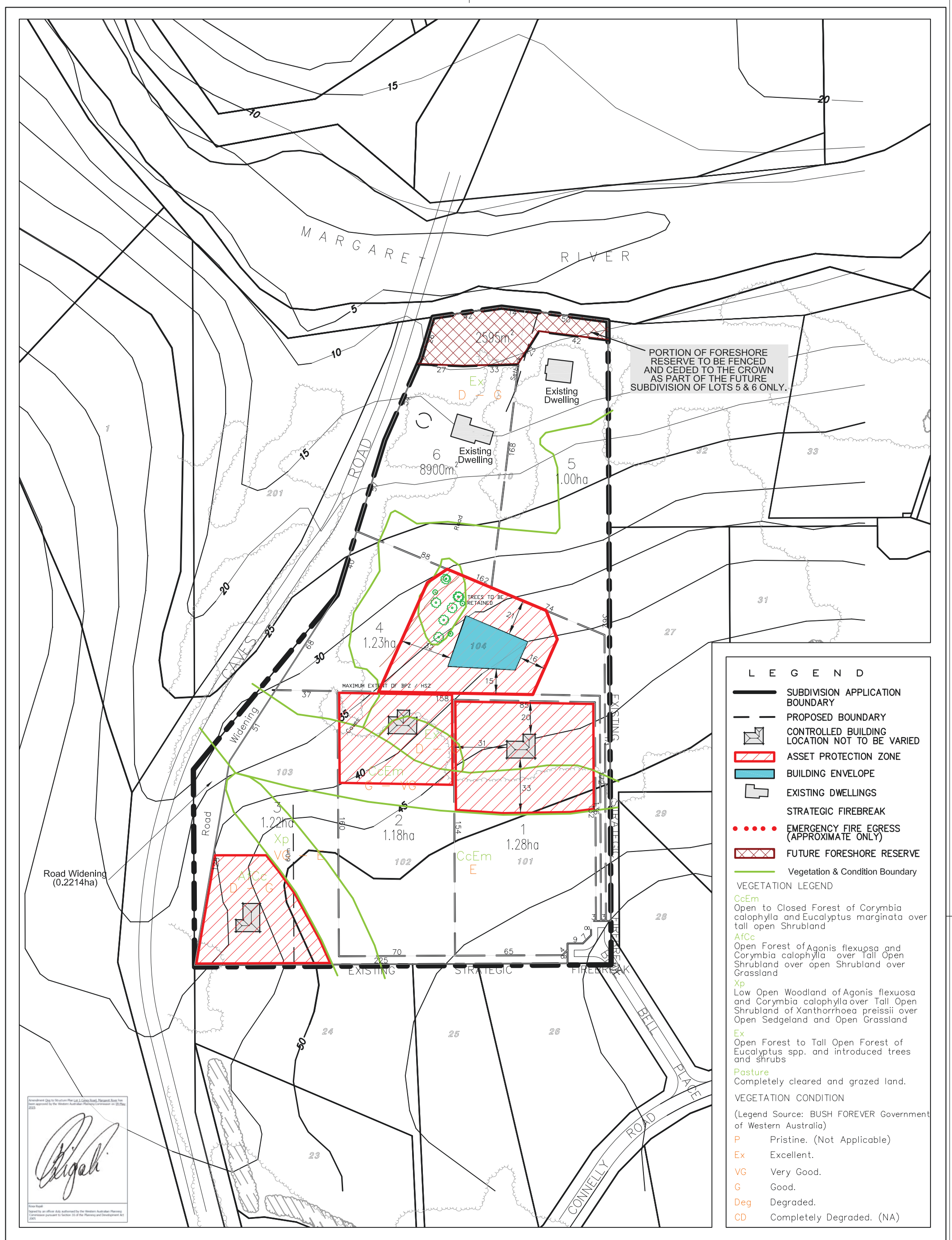

LEGEND

- SUBDIVISION APPLICATION BOUNDARY
- PROPOSED BOUNDARY
- CONTROLLED BUILDING LOCATION NOT TO BE VARIED
- ASSET PROTECTION ZONE
- BUILDING ENVELOPE
- EXISTING DWELLINGS
- STRATEGIC FIREBREAK
- EMERGENCY FIRE EGRESS (APPROXIMATE ONLY)
- FUTURE FORESHORE RESERVE
- Vegetation & Condition Boundary

VEGETATION LEGEND

- CcEm**
Open to Closed Forest of *Corymbia calophylla* and *Eucalyptus marginata* over tall open Shrubland
- AfCc**
Open Forest of *Agonis flexuosa* and *Corymbia calophylla* over Tall Open Shrubland over open Shrubland over Grassland
- Xp**
Low Open Woodland of *Agonis flexuosa* and *Corymbia calophylla* over Tall Open Shrubland of *Xanthorrhoea preissii* over Open Sedgeland and Open Grassland
- Ex**
Open Forest to Tall Open Forest of *Eucalyptus* spp. and introduced trees and shrubs
- Pasture**
Completely cleared and grazed land.

VEGETATION CONDITION

(Legend Source: BUSH FOREVER Government of Western Australia)

- P** Pristine. (Not Applicable)
- Ex** Excellent.
- VG** Very Good.
- G** Good.
- Deg** Degraded.
- CD** Completely Degraded. (NA)

Amendment City of Structure Plan Lot 2, Caves Road, Margaret River for approval by the Western Australian Planning Commission on 08/08/2018

Scale: 1:1000
 Approved by an official duly authorized by the Western Australian Planning Commission pursuant to Section 16 of the Planning and Development Act 2005.



STRUCTURE PLAN LOTS 101 - 104 & 110 BLUEBELL PLACE, MARGARET RIVER

Revision	Date	Item
n	12/11/2018	Adjust building location for Lot 104
m	27/10/2017	Adjust building location for Lot 104
l	31/12/2016	Adjust building location for Lot 104
k	19/08/2009	Add foreshore reserve / add emergency egress
j	03/11/2008	Adjust building location for Lot 2
i	23/10/2008	Redesign
h	13/10/2008	Altered lots 2 & 4 for road widening.
g	07/06/2007	Using revision "E" relocated building envelopes for lots

NOTES

Base data supplied by Landgate
 Aerial Photography dated January 2003, accuracy +/- 4m, Projection MGA95

Areas and dimensions shown are subject to final survey calculations.
 All cartographies are shown for illustrative purposes only and are subject to detailed engineering design.

The concepts presented in this plan remain the © copyright of RPS KOLTASZ SMITH.
 No copies in whole or in part may be made without RPS KOLTASZ SMITH's permission.



PEIRCE : CLIENT
 A1@1:1,000 : SCALE
 A3@1:2,000 : DATE
 12 November 2018 : PLAN No
 11205-3-001 : REVISION
 n : PLANNER
 P.G : DRAWN
 B.L

TOWN PLANNING PROJECT MANAGEMENT URBAN DESIGN DEVELOPMENT CONSULTING
 Unit 1 / 8 Prince Street BUSSETON WA 6280 Tel: (08) 9754 2898 Fax: (08) 9754 2085
 PO Box 749 BUSSETON WA 6280 Email: busseton@ksap.com.au

© copyright of RPS KOLTASZ SMITH. No copies in whole or in part may be made without permission.