

An aerial 3D rendering of a proposed residential development. The plan shows a large area with various housing types, including single-family homes and multi-unit buildings. There are several green spaces, including a large rectangular field in the upper left and several smaller parks or courtyards. The development is surrounded by existing residential areas and a road on the right side. The text "NORTH ELLENBROOK WEST - DISTRICT STRUCTURE PLAN: 3D VISIONING" is overlaid in white, bold, sans-serif font across the middle of the image.

NORTH ELLENBROOK WEST - DISTRICT STRUCTURE PLAN: 3D VISIONING

PURPOSE

The North Ellenbrook West District Structure Plan ('NEW DSP') design review was informed by a detailed landform model developed to consider the site context and local opportunities and constraints. Subsequent masterplan work developed this model as a tool to consider responses to key policy considerations, density targets and interface to the public realm. The model will be retained to continually inform ongoing planning responses at the NEW DSP progresses.



PLATE 1: View north-east to Chudalup Road



PLATE 2: South-east view from Della South Road, adjacent conservation open space

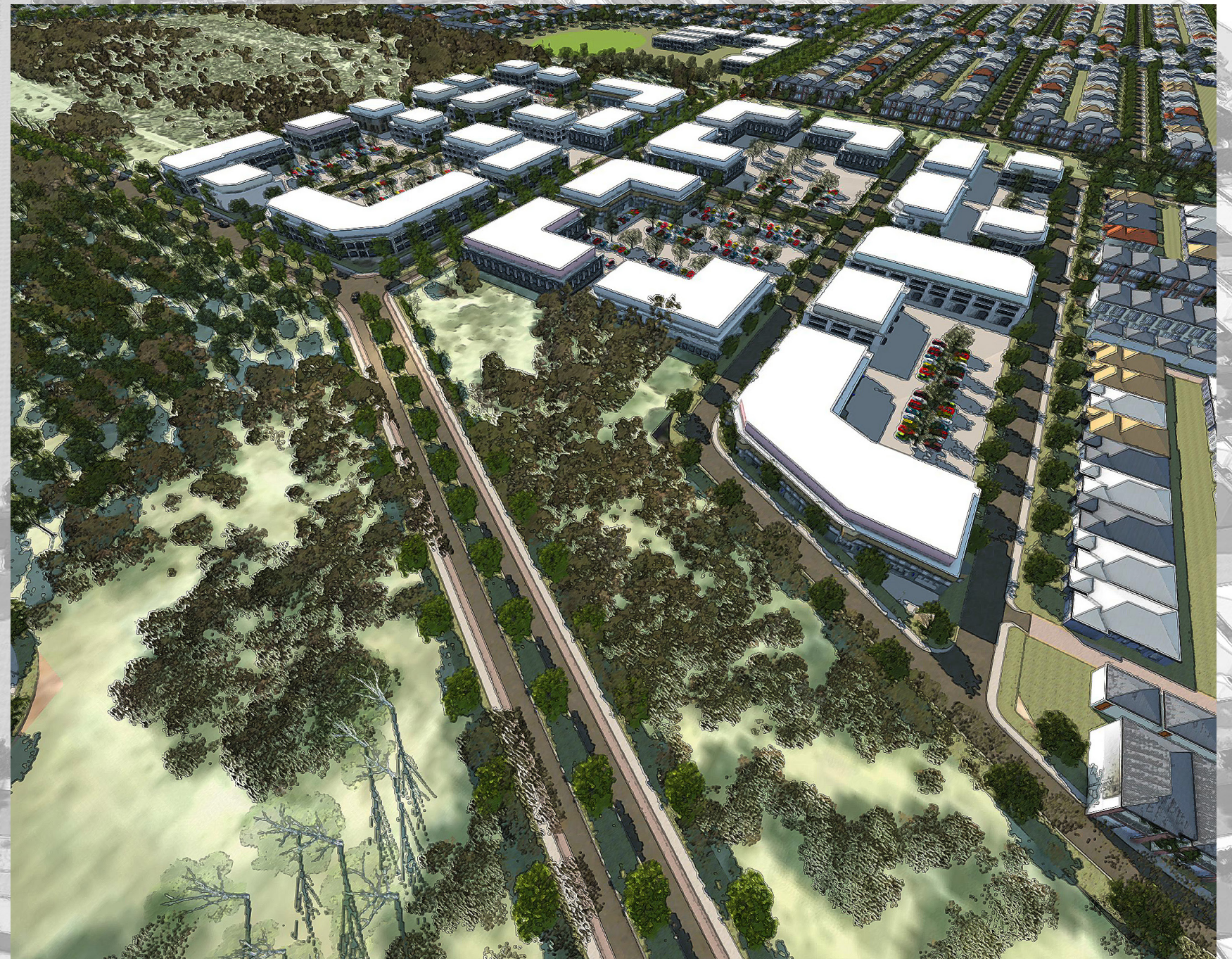

PLATE 3: Main entry boulevard to District Centre



PLATE 4: View west from Perth to Darwin National Highway



PLATE 5: View north from Halden Road

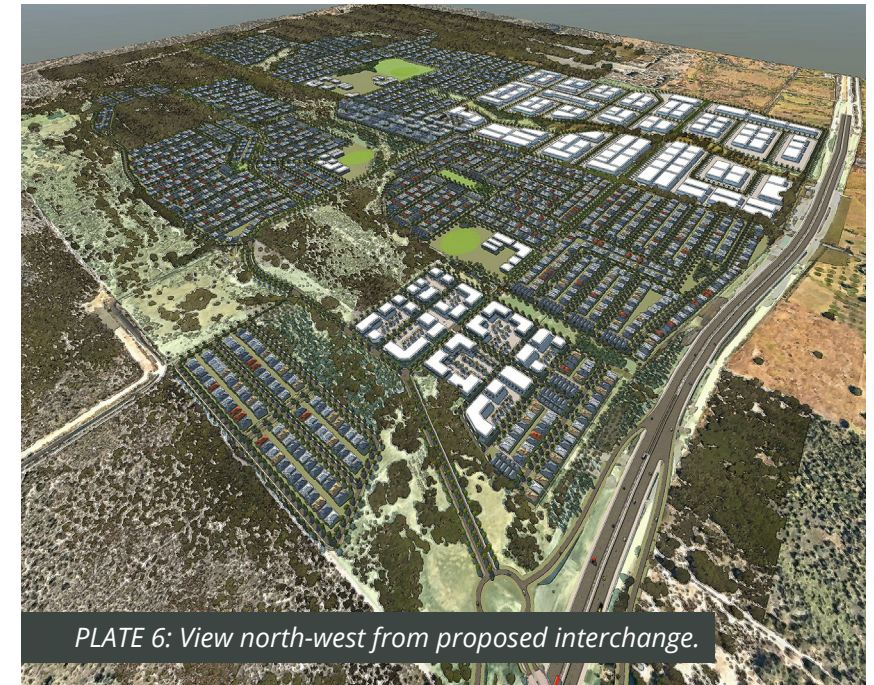

PLATE 6: View north-west from proposed interchange.



PLATE 7: Site Overview - Northern View







PLATE 11: Site Overview - Western View



PLATE 12: View east to LSP area 1

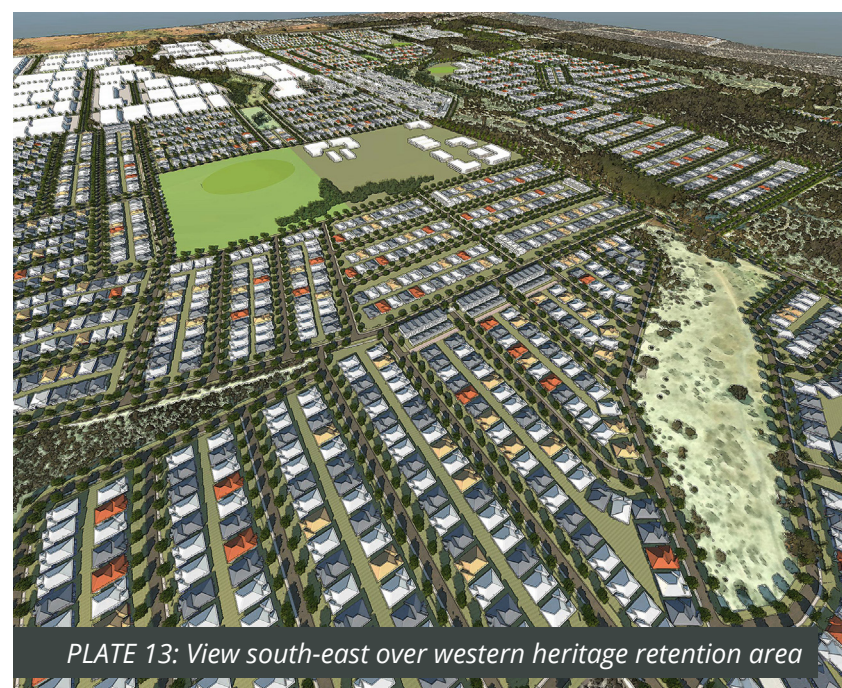

PLATE 13: View south-east over western heritage retention area



PLATE 14: View west over District Centre and LSP Area 1





PLATE 15: Proposed interchange view north-west



PLATE 16: Neighbourhood centre view south



PLATE 17: Main street view north





PLATE 18: District Centre view north



PLATE 19: Neighbourhood centre view south-west Road

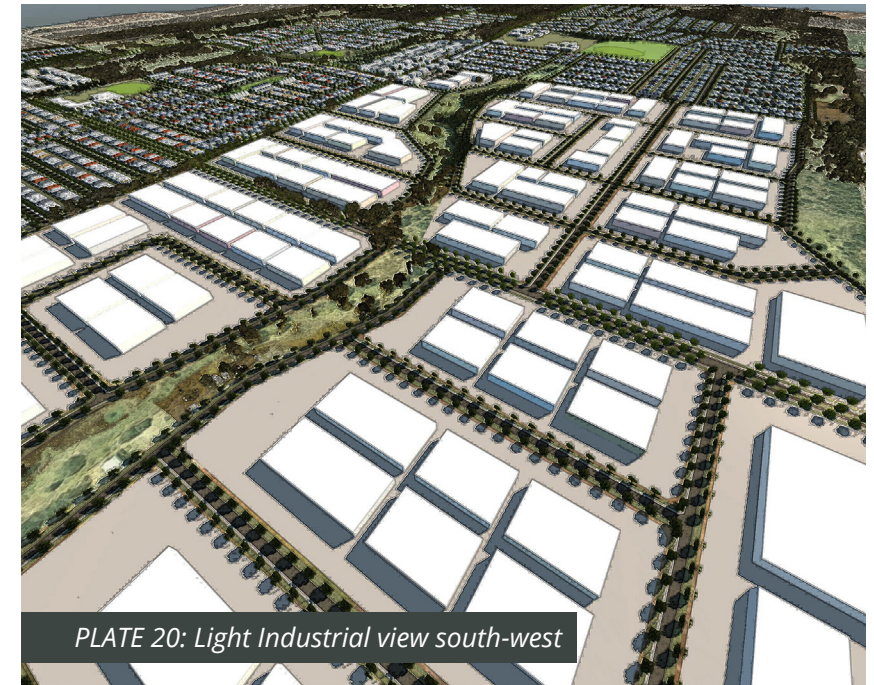

PLATE 20: Light Industrial view south-west



PLATE 21: Proposed Perth to Darwin National Highway Interchange View

