

ENDORSEMENT PAGE

IT IS CERTIFIED THAT THIS STRUCTURE PLAN WAS APPROVED BY RESOLUTION OF THE
WESTERN AUSTRALIAN PLANNING COMMISSION ON:

20 October 2005

In accordance with Schedule 2, Part 4, Clause 28 (2) and refer to Part 1, 2. (b) of the
Planning and Development (Local Planning Schemes) Regulations 2015.

Date of Expiry: 19 October 2025

TABLE OF AMENDMENTS

Amendment No.	WAPC Endorsed Date
Original	20 October 2005
1	12 June 2009

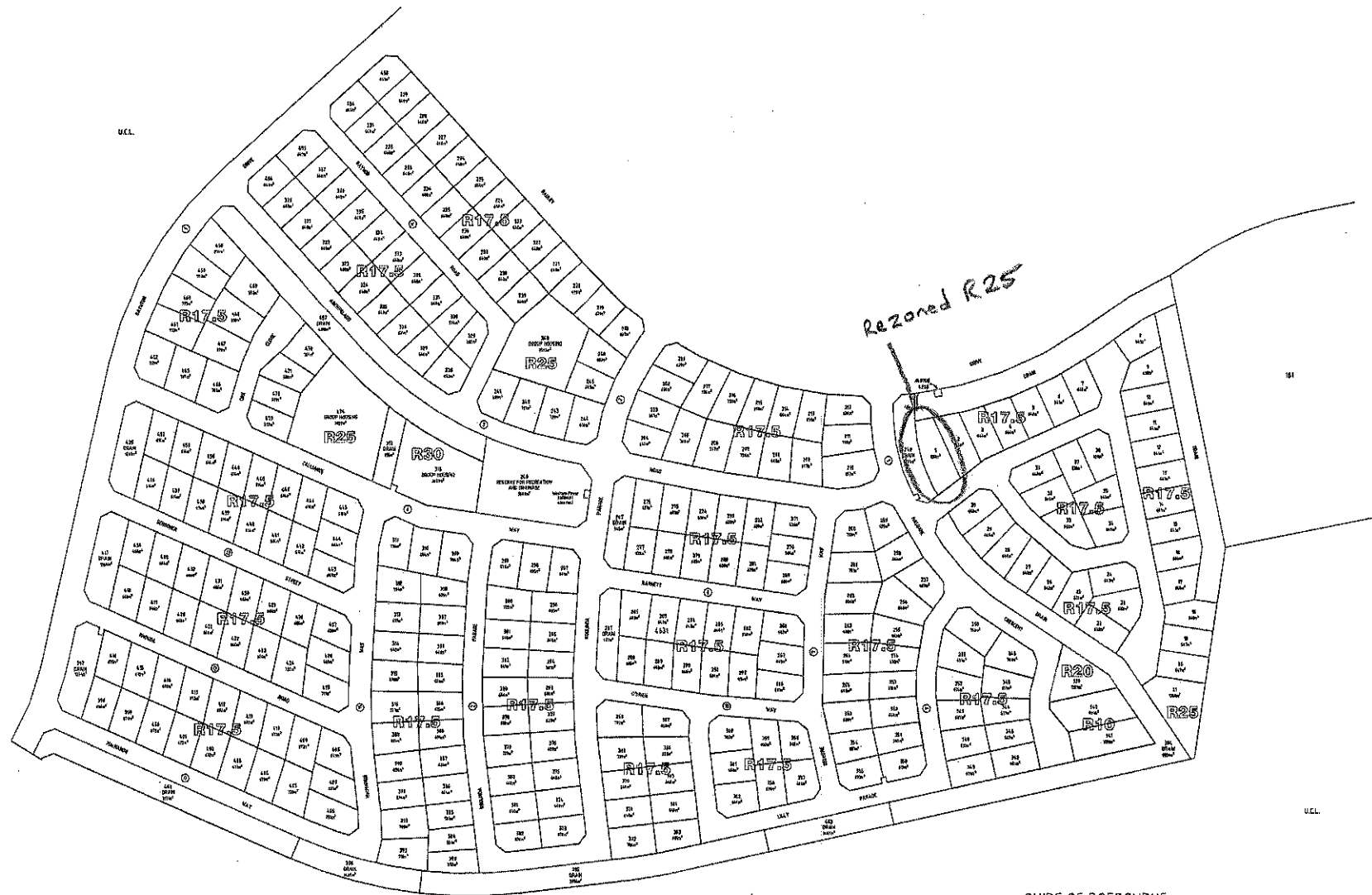

SHIRE OF ROEBOURNE
TOWN PLANNING SCHEME NO 8
DEVELOPMENT PLAN
BAYNTON AREA C
ADOPTED BY COUNCIL (19 SEPTEMBER 2005)
1: 3000 (A3)

KARRATHA
Hillcrest Estate
Stage 10
FP-07539-024-Rev.1.0
PNH 01.03.2006

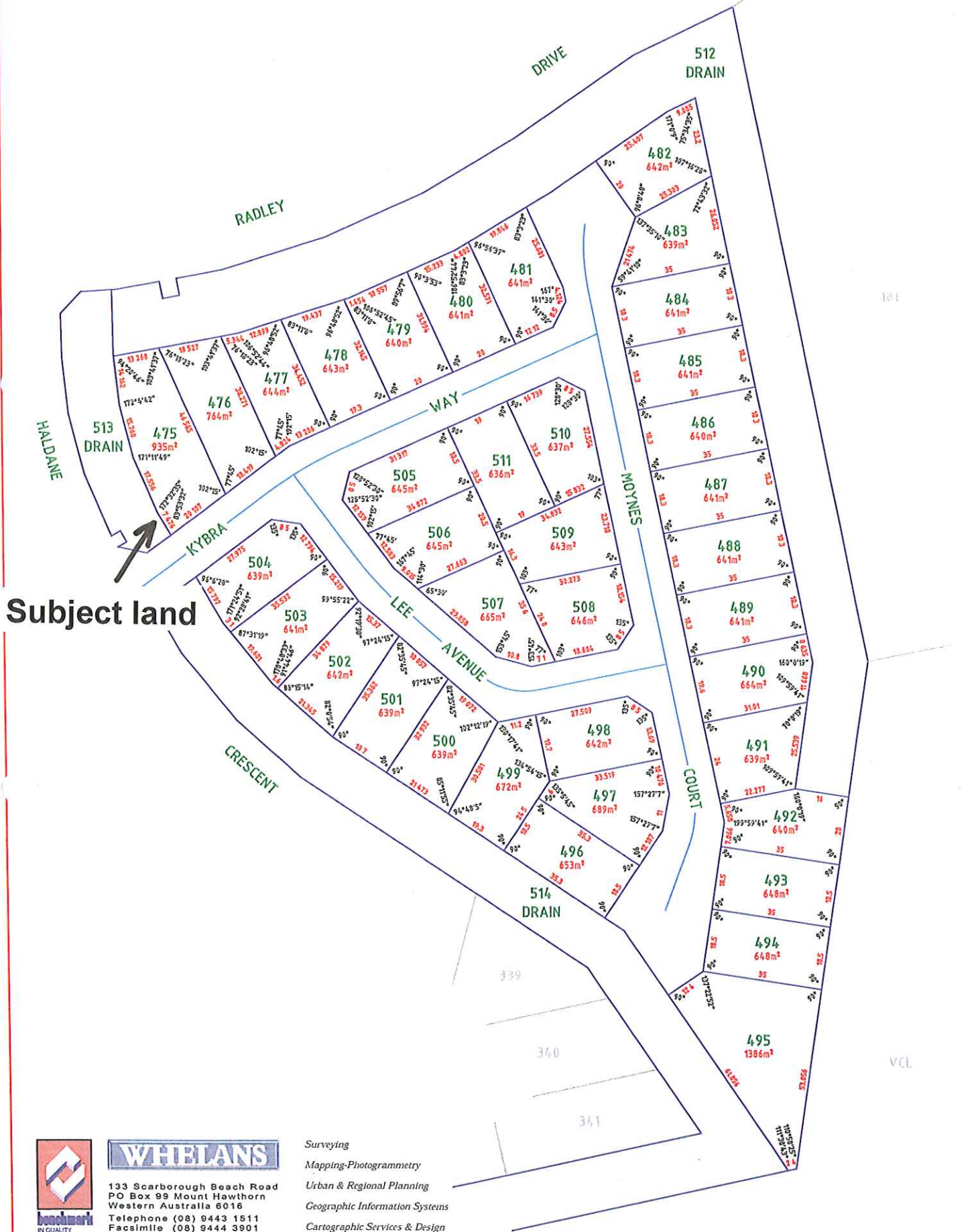

All Dimensions & areas are subject to survey. This plan must not be reproduced without the permission of WHELAN'S.