

ENDORSEMENT PAGE

This structure plan is prepared under the provisions of the City of Albany Local Planning Scheme No. 2.

IT IS CERTIFIED THAT THIS STRUCTURE PLAN WAS APPROVED BY RESOLUTION OF THE WESTERN AUSTRALIAN PLANNING COMMISSION ON:

27 OCTOBER 2015

In accordance with Schedule 2, Part 4, Clause 28 (2) and refer to Part 1, 2. (b) of the *Planning and Development (Local Planning Schemes) Regulations 2015*.

Date of Expiry:

27 OCTOBER 2027

DEVELOPMENT GUIDE PLAN

General Industrial Area IA2

Pendeen Industrial Estate

Adopted by Resolution of the Council of the City of Albany at the ordinary meeting of the Council held on the 27th day of October 2015.

Chief Executive Officer

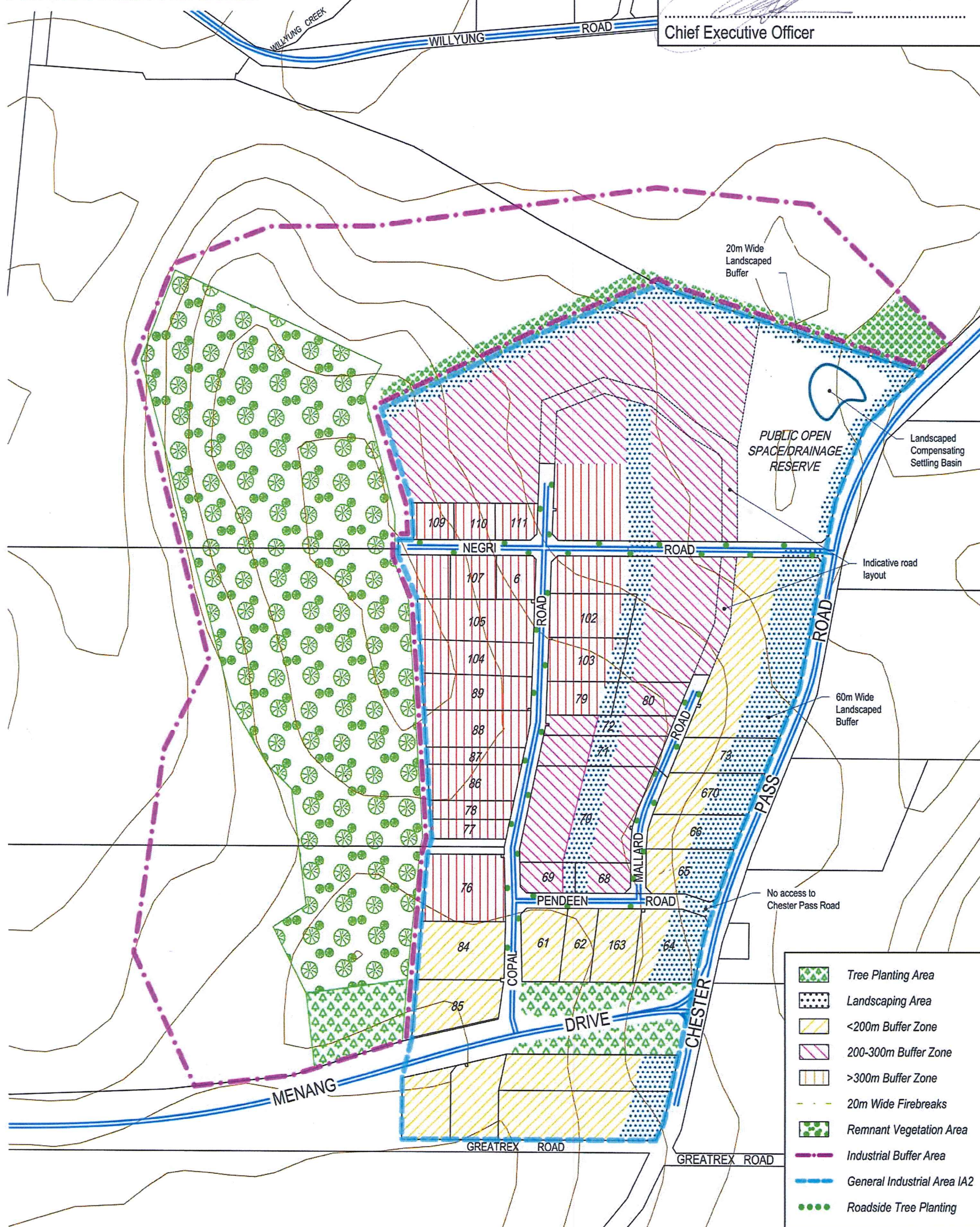

0 100 200 300
SCALE 1:6000 (A3)

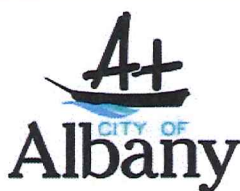

102 NORTH ROAD, YAKAMIA WA 6330
PO BOX 484 ALBANY WA 6331
Tel: (08) 9841 9333
Fax: (08) 9841 4099
Email: cityassets@albany.wa.gov.au
Website: www.albany.wa.gov.au

PROJECT PENDEEN INDUSTRIAL ESTATE

LOCATION
PENDEEN INDUSTRIAL ESTATE
WILLYUNG, CITY OF ALBANY

DRAWING SCALE
1:1000 @ A4

APRIL 2015