

ENDORSEMENT PAGE

This structure plan is prepared under the provisions of the Shire of Manjimup
Local Planning Scheme No. 4

IT IS CERTIFIED THAT THIS STRUCTURE PLAN WAS APPROVED BY RESOLUTION OF THE
WESTERN AUSTRALIAN PLANNING COMMISSION ON:

19 October 2015

In accordance with Schedule 2, Part 4, Clause 28 (2) and refer to Part 1, 2. (b) of the *Planning and Development (Local Planning Schemes) Regulations 2015*.

Date of Expiry:

19 OCTOBER 2027



This plan has been prepared for planning purposes only. Areas, contours and dimensions are subject to detailed survey.

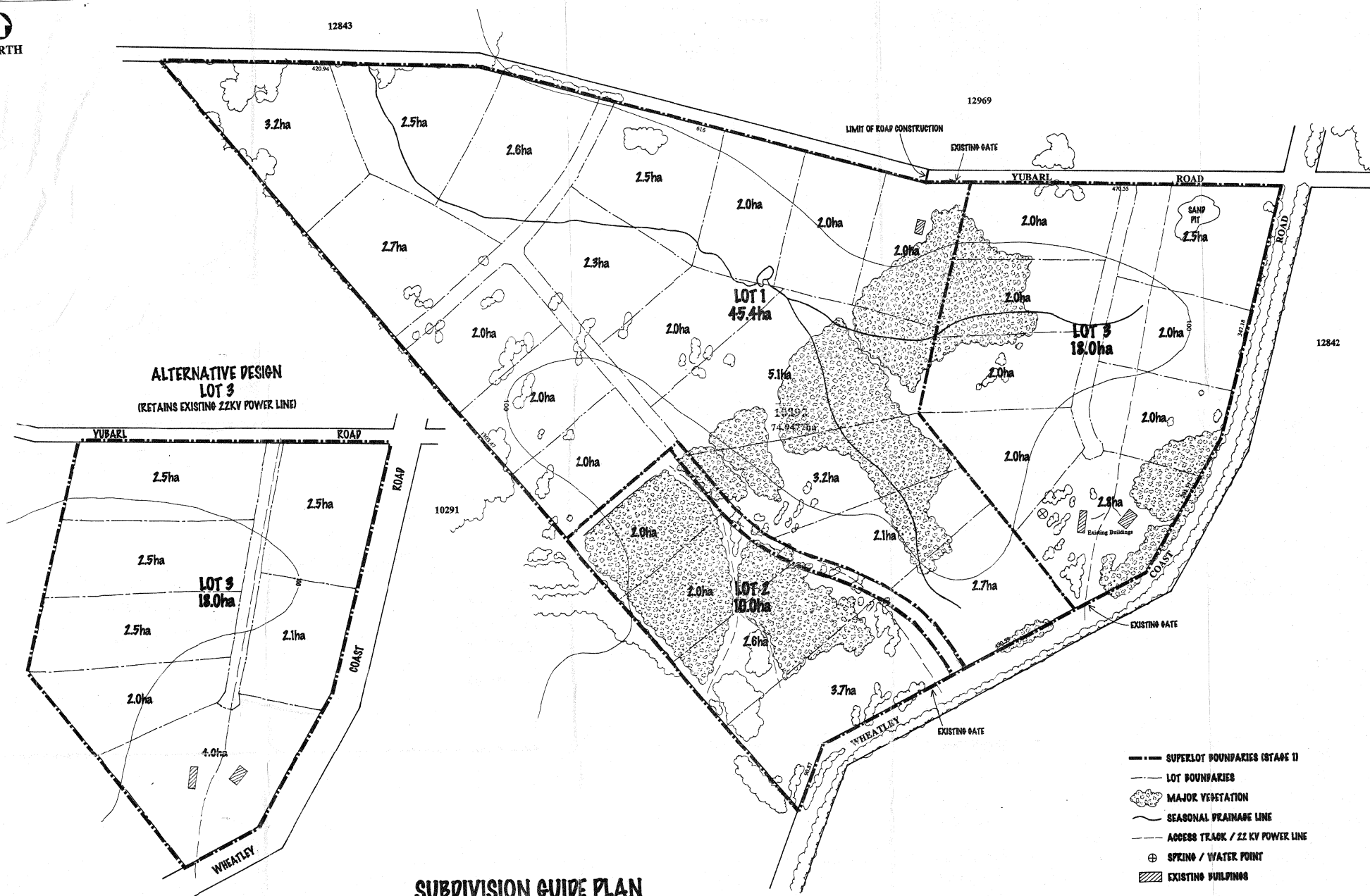

**ALTERNATIVE DESIGN
LOT 3**
(RETAINS EXISTING 22KV POWER LINE)

**SUBDIVISION GUIDE PLAN
NELSON LOCATION 10292
WHEATLEY COAST ROAD
NORTHCLIFFE**

- SUPERLOT BOUNDARIES (STAGE 1)
- LOT BOUNDARIES
- MAJOR VEGETATION
- SEASONAL DRAINAGE LINE
- ACCESS TRACK / 22 KV POWER LINE
- ⊕ SPRING / WATER POINT
- EXISTING BUILDINGS