

WESTERN AUSTRALIA'S ***State Infrastructure Programme 2025***



Acknowledgement of Country

The Government of WA acknowledges the traditional custodians throughout WA and their continuing connection to the land, waters and community.

We pay our respects to all members of Aboriginal communities and their cultures; and to Elders both past and present.

Disclaimer

This publication reflects information as at the time of release. None of the information in this publication should be relied upon unless and until those seeking to rely on it have independently verified the accuracy and completeness of it.

Using this document

[Text in this colour is a link to an external source \(e.g. web page\)](#)

[Text in this colour is a link to an internal page](#)



CONTENTS

Premier's foreword	4
Chapter 1 Overview	6
The State Infrastructure Programme	7
Document Overview and Structure	7
Infrastructure Investment Overview	8
Chapter 2 Significant Infrastructure Investments	10
Jobs and Economic Development	12
Health	19
Education and Training	22
Community Safety	26
Transport and Major Infrastructure	27
Environment	41
Planning and Land Use	43
Water	47
Energy	49
Chapter 3 Infrastructure Outlook	51
Demographic changes	53
Workforce	54
Housing	55
Transport	56
Economic development	58
Energy transition	59
Emerging technologies	60
Future trends and initiatives	61
Find Out More	62
Appendix 1: List of Significant Infrastructure Commitments	64



Premier's foreword

Infrastructure is the backbone of Western Australia's prosperity – driving economic growth, strengthening communities, and laying the groundwork for a more resilient future.

I am pleased to release the WA Government's 2025 State Infrastructure Programme, providing an overview of WA's infrastructure investments, needs and opportunities.

With a significant \$38 billion infrastructure pipeline over the next four years, our Government is investing with purpose and ambition – building the hospitals, schools, community facilities, transportation and vital utilities that will serve us now and for generations to come.

We recognise that to grow as a State, no region can be left behind. That's why we are delivering a \$10.3 billion pipeline of regional infrastructure investment, supporting essential services and connectivity in every corner of Western Australia. This is complemented by an additional \$1.4 billion commitment to boosting housing supply and affordability, both in Perth's suburbs and across the regions, through a mix of innovative delivery approaches that will reshape the way housing is planned and built.

Through our Made in WA plan, we are capitalising on Western Australia's position as a global resources leader, while accelerating efforts to diversify and decarbonise our economy. These investments are unlocking new industries, securing long-term prosperity, and positioning WA at the forefront of a changing global landscape.

Our success depends on the people who turn plans into reality. That's why the 2025–26 Budget invests \$331 million in TAFEs and training – ensuring we have a skilled workforce that can deliver critical infrastructure and thrive in the economy of tomorrow.

Together, we will build the infrastructure WA needs to thrive. The benefits will be felt now, and for generations to come.

This document has been developed with input from Infrastructure WA. I would like to thank Infrastructure WA and their board for their advice.



Hon. Roger Cook
Premier

Minister for:
State Development;
Trade and Investment; and
Economic Diversification



CHAPTER 1 OVERVIEW



The State Infrastructure Programme

The Premier is required to develop a State Infrastructure Programme each year in consultation with the Treasurer, under Section 18 of the *Infrastructure Western Australia Act 2019*.

The 2025 State Infrastructure Programme spans a ten-year period and includes:

- › an overview of the infrastructure commitments in the 2025-26 State Budget (covering the years 2025-26 to 2028-29); and
- › a longer-term outlook on the State's infrastructure needs and challenges.

This document has been developed by the Department of the Premier and Cabinet with support from the Department of Treasury and Finance and informed by independent advice from Infrastructure WA.

Document Overview and Structure

The WA Government's infrastructure investments are spread across our vast State and many different sectors. To ensure the breadth of this activity is captured, and is easily accessible to the reader, this document is divided into three main parts:

» Chapter 2: Significant Infrastructure Investments

This chapter provides an overview of key infrastructure investments in nine different sectors covering the years 2025-26 to 2028-29.

» Chapter 3: Infrastructure Outlook

This chapter outlines the emerging needs and challenges relating to Western Australian infrastructure in the six years following 2028-29. Reference to specific projects or initiatives in this chapter should not be interpreted as a commitment by Government to invest in these proposals. Consideration of specific projects may occur as part of future State Budget processes.

» Appendix 1: List of Significant Infrastructure Commitments

Appendix 1 provides a list of significant WA Government infrastructure commitments. A project is considered a significant investment if it is anticipated to cost over \$20 million.



Infrastructure Investment Overview

The 2025-26 State Budget forecasts an operating surplus of \$2.4 billion. Similar operating surpluses are forecast across the remainder of the forward estimates period (between \$2.4 billion and \$2.8 billion over 2026-27 to 2028-29). This will provide an important source of non-debt funding to finance the Government's significant investment in infrastructure.



ASSET INVESTMENT PROGRAM Total Public Sector

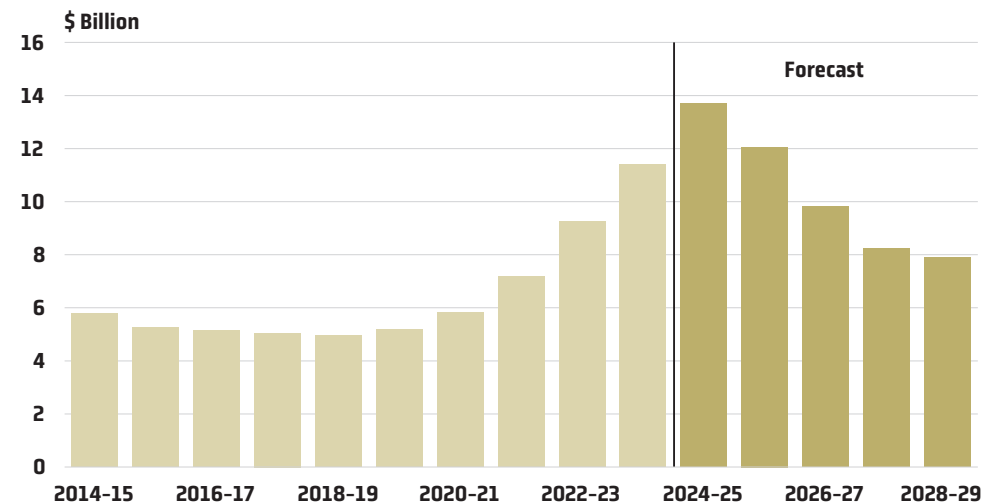
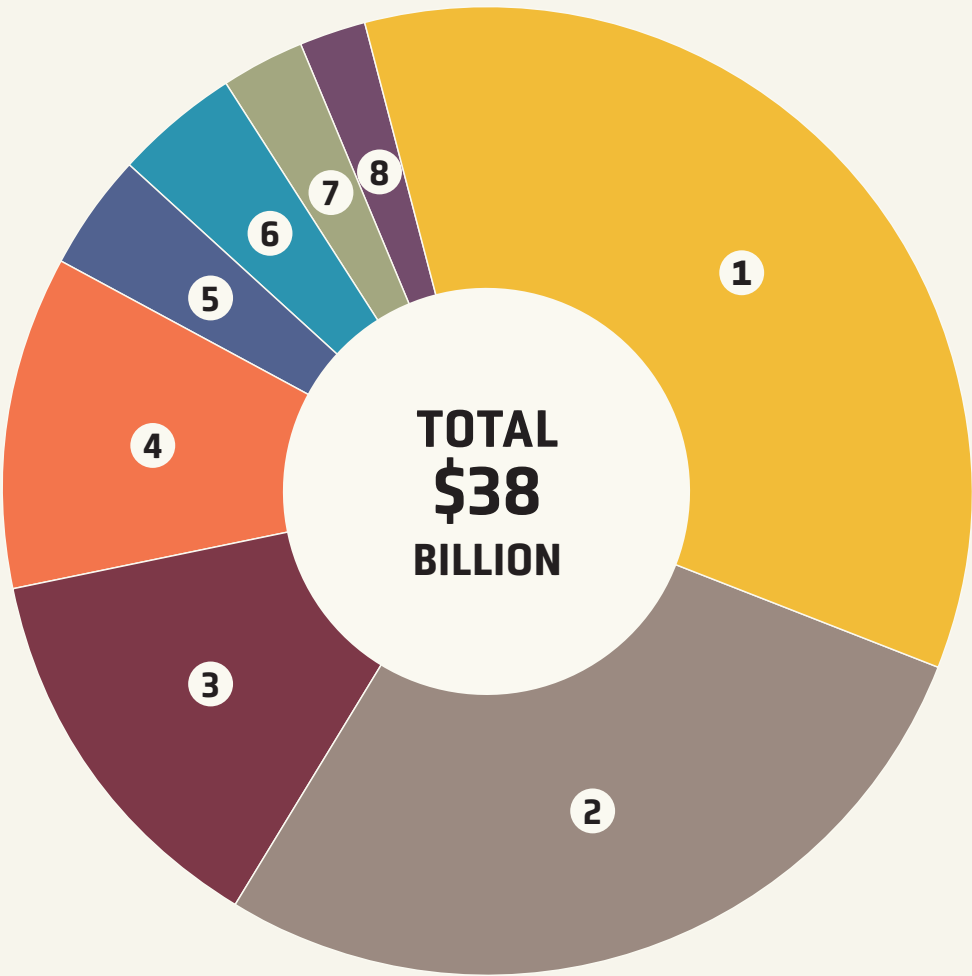

Figure 1. WA Asset Investment Program spend annually, 2025-26 WA State Budget

The State's Asset Investment Program (AIP) totals \$38.0 billion over the forward estimates (from 2025-26 to 2028-29), including \$12.1 billion of spending in 2025-26. General government sector investment represents \$13.9 billion (or 36.6% of the total program), with the public non-financial corporation sector responsible for the remaining \$24.1 billion.

The WA Government continues to invest in infrastructure required for our rapidly growing State. Key areas of investment across the forward estimates are utility infrastructure (\$13.3 billion); road, rail, and transport projects (\$10.7 billion); public and affordable housing and land development (\$4 billion); health infrastructure (\$3.2 billion); ports (\$1.7 billion) and education (\$1.7 billion). This pipeline will facilitate economic diversification, create local jobs, drive new industry growth, and strengthen communities across the State.



ASSET INVESTMENT PROGRAM 2025-26 to 2028-29

SEGMENT		\$m	%
1	Utilities	13,276	35
2	Transport	10,737	28
3	Health, Education and Training	5,070	13
4	Communities, Housing and Land	4,007	11
5	Ports	1,688	4
6	All Other	1,422	4
7	Sports, Culture and Attractions	1,125	3
8	Community Safety	691	2

Note: Segments may not add due to rounding.

Figure 2.
WA Asset Investment Program, 2025-26 WA State Budget

Further information on Western Australia’s economic and financial performance, including infrastructure investment, can be found in the [WA State Budget 2025-26](#).

CHAPTER 2

SIGNIFICANT INFRASTRUCTURE INVESTMENTS





This chapter provides an overview of the WA Government's key infrastructure investments in the following sectors:

- › Jobs and Economic Development
- › Health
- › Education and Training
- › Community Safety
- › Transport and Major Infrastructure
- › Environment
- › Planning and Land Use
- › Water
- › Energy

Appendix 1 provides a full list of Government infrastructure commitments over \$20 million which are sorted according to the sectors outlined above.



Jobs and Economic Development

Infrastructure is key to keeping our economy strong and facilitating job creation. The WA Government is helping to ensure the State is equipped to succeed in an evolving global economy by diversifying our industry and investing in workforce development. These investments foster innovation, empower WA business, and continue to unlock opportunities across the State.



Industry and Economic Diversification

Industry is a key pillar of WA's economic prosperity. This prosperity is underpinned by our vast mineral and agricultural wealth, as well as emerging industries such as clean energy and defence. Diverse and resilient industries will be key to supporting the jobs of the future while ensuring WA continues to prosper amid dynamic global change and uncertainty.

Significant government investments in this space include:

- › An additional \$500 million in the 2025-26 Budget for the Strategic Industries Fund, with investment now totalling \$1 billion, to support delivery of common user infrastructure and enabling works across WA's Strategic Industrial Areas;
- › An additional \$30 million in the 2025-26 Budget for the Collie Industrial Transition Fund, to secure new job creating projects and to further support Collie's transition away from coal-fired power generation; and
- › \$25 million from 2025-26 to 2028-29 to expand manufacturing facilities in Forrestfield, establish a Local Industry Development Fund and to support the establishment of the Advanced Manufacturing Technology Hub in Picton.

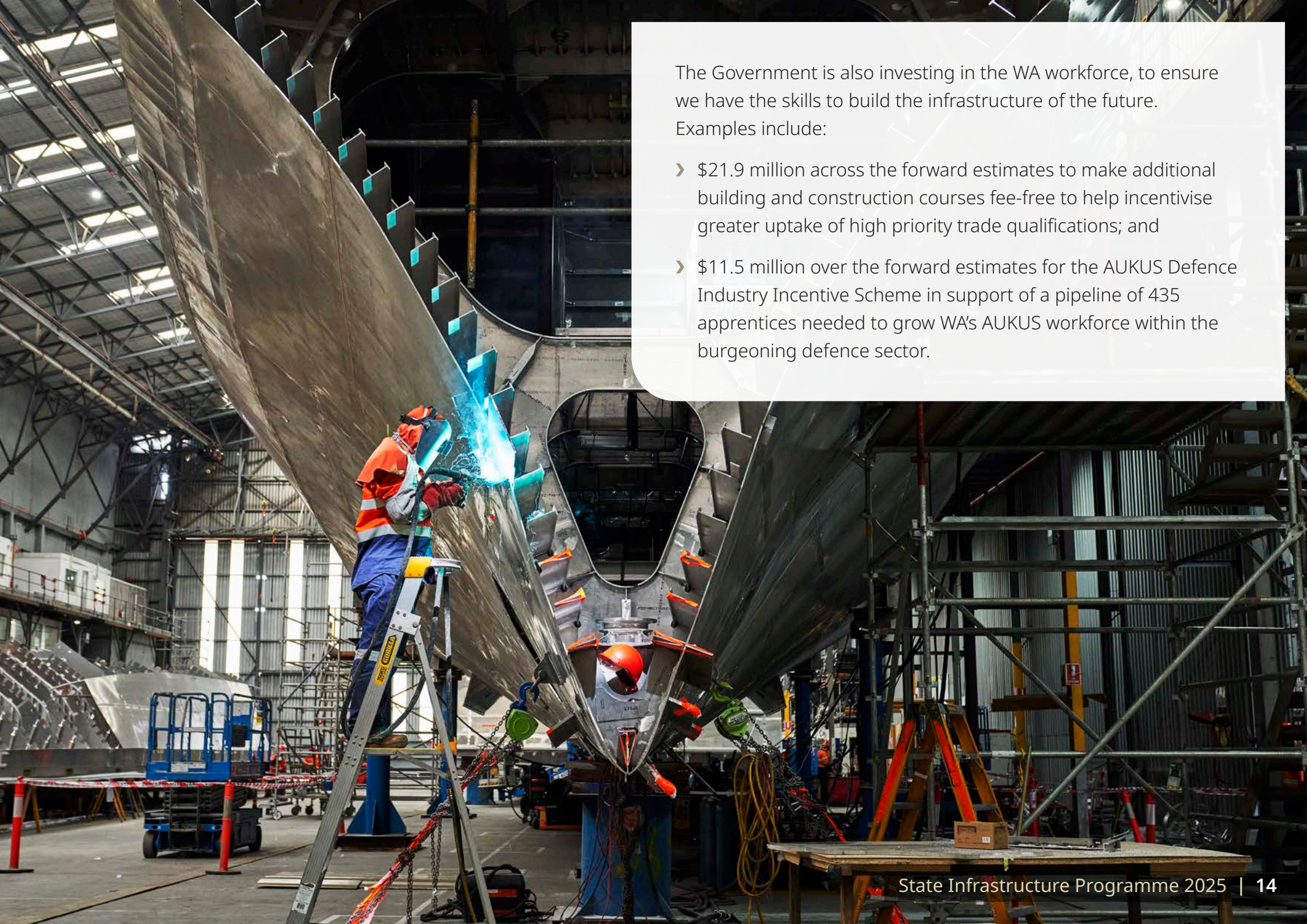

The Government is also investing in the WA workforce, to ensure we have the skills to build the infrastructure of the future. Examples include:

- › \$21.9 million across the forward estimates to make additional building and construction courses fee-free to help incentivise greater uptake of high priority trade qualifications; and
- › \$11.5 million over the forward estimates for the AUKUS Defence Industry Incentive Scheme in support of a pipeline of 435 apprentices needed to grow WA's AUKUS workforce within the burgeoning defence sector.

Creative Industries, Tourism and Sport

High-quality infrastructure is a catalyst for WA's creative, tourism, and sporting sectors – supporting vibrant, inclusive spaces that celebrate local culture and welcome the world. This new infrastructure allows WA to host major events, create new jobs, and secure even more investment. Aside from economic benefits, these sectors showcase WA and our talent while strengthening community pride and cross-cultural connection.



Key infrastructure investments in these sectors include:

- › \$233.5 million to construct the Perth Film Studios, including \$47.7 million in 2025-26, to deliver WA's first dedicated screen production facility;
- › \$163.2 million to build the Australian Hockey Centre, helping to secure WA as Australia's premier hockey destination via a new high-performance training facility and international competition venue;
- › \$150.3 million for the redevelopment of the Perth Concert Hall to reinvigorate this iconic State cultural institution, which includes \$12 million from the Commonwealth Government, \$4 million from the City of Perth and \$30 million from Woodside through the Resources Community Investment Initiative; and
- › \$55 million towards the redevelopment of the Perth Cultural Centre ensuring the precinct continues to champion the State's unique heritage and arts industries.



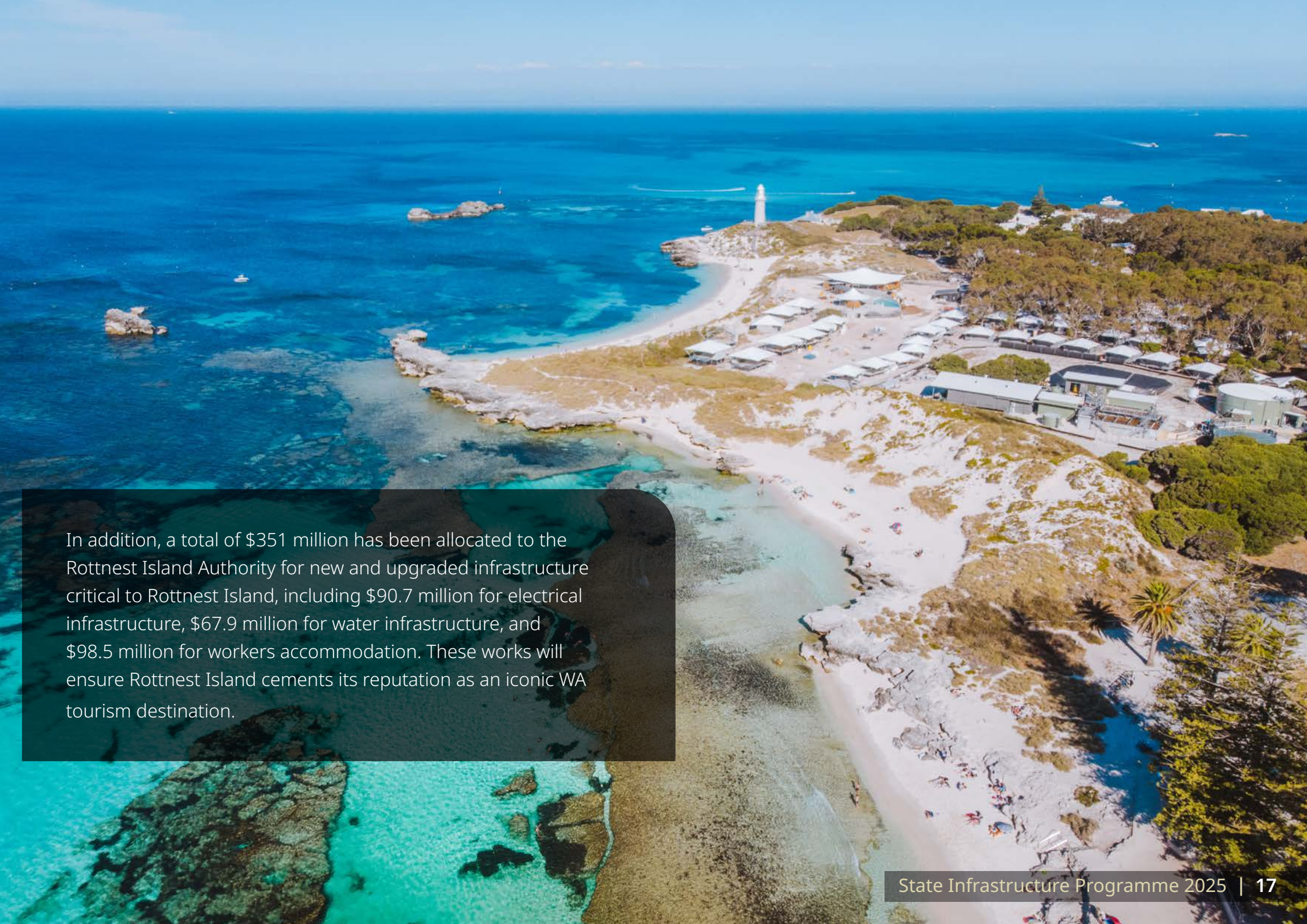

In addition, a total of \$351 million has been allocated to the Rottnest Island Authority for new and upgraded infrastructure critical to Rottnest Island, including \$90.7 million for electrical infrastructure, \$67.9 million for water infrastructure, and \$98.5 million for workers accommodation. These works will ensure Rottnest Island cements its reputation as an iconic WA tourism destination.

Primary Industries and our Regions

With strong links to research and development, WA is well placed to meet the growing global demand for primary exports. The Department of Primary Industries and Regional Development's Asset Investment Program (AIP) includes a total of \$574.1 million committed towards assets that will support the growth of WA's agriculture, food and aquatic industries, and the prosperity of our regions. This includes new investment of \$55.7 million in 2025-26 to establish a Primary Industries Development Research Facility in the Perth metropolitan area, which will strengthen WA's biosecurity and leverage innovation within the agricultural sector.



Health

Well planned and integrated health infrastructure is critical to ensuring all Western Australians have access to quality health services.

WA Health's AIP is valued at approximately \$3.2 billion over the forward estimates period and includes a mixture of new asset investment, the improvement and expansion of existing assets, and planning for future projects.

Women and Babies Hospital Project

A total of \$1.8 billion has been allocated to expand services and choice for women, newborns and families across three sites, including a new Women and Babies Hospital located at the Fiona Stanley Hospital precinct in Murdoch and two new family birth centres – one north and one south of the river.



Bunbury Hospital Redevelopment

\$471.5 million is committed to the redevelopment of Bunbury Hospital. The redevelopment will deliver additional medical and intensive care beds, an expanded emergency department, increased operating theatre capacity, and maternity, birthing and neonatal services.

Medical Equipment and Imaging Replacement Program

The \$748.8 million Medical Imaging and Replacement Program comprises capital works to modernise healthcare equipment. The 2025-26 Budget includes a \$93 million investment in the Program over the forward estimates.

Geraldton Health Campus Redevelopment

Construction is progressing on the \$190.2 million redevelopment of the Geraldton Health Campus. This investment will deliver an expanded emergency department, a new intensive care unit, and an integrated mental health service, including an adult mental health inpatient unit and a mental health short stay unit.

Graylands Reconfiguration and Forensics Project

\$186.2 million will be invested in the Graylands Reconfiguration and Forensics Project across the forward estimates, to ensure the Graylands site continues to meet the needs of Western Australians living with mental illness now and in the future.

Bentley Health Service - Surgicentre

Work is progressing on the \$166.7 million Bentley Surgicentre. The Surgicentre will reduce wait times by separating non-complex elective surgery from emergency surgery, and deliver additional operating theatres, a surgical ward and new procedure rooms at the current Bentley Hospital site.

Peel Health Campus Redevelopment

\$117.1 million has been allocated across 2025-26 to 2028-29 for the redevelopment of the Peel Health Campus and expansion of its emergency department. These works include additional inpatient beds, a new mental health inpatient ward and emergency centre, an additional operating theatre, a palliative care hospice and additional chemotherapy spaces.





Education and Training

Uplifting the State's current and future workforce capabilities is fundamental to WA's prosperity. Investing in our schools and TAFEs provides students with the skills they need to respond to opportunities in emerging industries and rapidly changing ways of work.

Education

The Department of Education's AIP totals \$1.7 billion from 2025-26 to 2028-29 for new public schools and improved infrastructure, including \$668.9 million to be spent in 2025-26. These investments will facilitate the delivery of high-quality educational infrastructure across the State, supporting students and educators in developing skills and knowledge for the future.



Significant projects include:

- › \$316 million for major upgrades to infrastructure at 17 primary and secondary schools and education support centres across the State;
- › \$94.4 million from 2025-26 to 2026-27 for transportable classrooms to support schools in meeting temporary, short to medium-term fluctuations in student enrolments;
- › \$85.3 million in 2025-26 to 2026-27 for the first tranche of minor upgrades to classrooms, sporting facilities and play equipment, which includes the \$43.3 million Cool the Schools program;
- › \$14 million in 2025-26 for planning and delivery of Stage 1 of the Brabham Senior High School, to accommodate 1000 students in the rapidly growing north-eastern suburb; and
- › \$4.5 million to expand infrastructure to support the four year-old kindergarten pilot program, forming part of the Government's \$33.8 million investment to trial the program at 10 sites across WA.

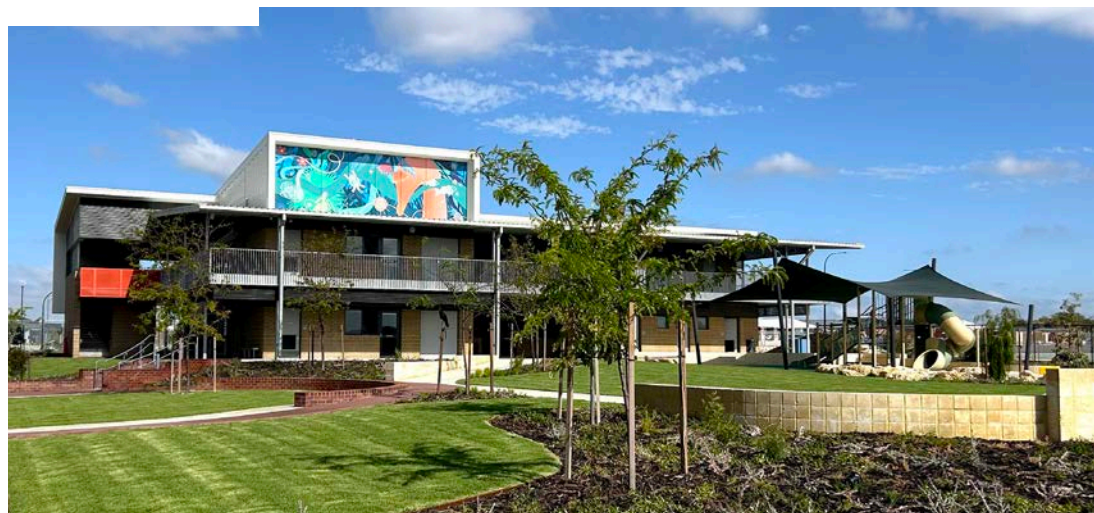

Training

High quality training facilities ensure every student can build the skills they need for the future. \$211.9 million has been invested over the forward estimates period towards training infrastructure. This will expand training opportunities available within the State, positioning the workforce to respond to the increasing demand for skilled labour.

Key government investments include:

- › \$61.5 million for the Department of Training and Workforce Development's Remedial Works Program from 2025-26 through 2028-29, enabling the upgrade of ageing infrastructure across WA's training facilities;
- › \$43.4 million, including \$33.9 million over the forward estimates, to ensure our TAFEs have the modern equipment they need to deliver the best training outcomes;
- › \$36.6 million from 2025-26 through 2027-28 towards renewables training equipment at the Clean Energy Skills National Centre of Excellence, to support the State's growing renewable energies sector; and
- › \$12.5 million over the forward estimates to establish a Heavy Vehicle Driver Training Facility at the North Metropolitan TAFE.





Community Safety

Investment in police stations, emergency and custodial infrastructure is integral to our community – supporting the capabilities of WA's emergency services and working to reduce crime, promote security, and foster safe communities.

Major infrastructure investments include:

- › \$254.1 million for Stage Two of the Casuarina Prison Expansion;
- › \$193.9 million to support the delivery of the Fremantle Police Complex, the Baldivis Police Station and the Forrestfield Police Station;
- › \$150.9 million on land and building works for fire and emergency services, including \$18.3 million to construct a new Career Fire and Rescue Services station in the Yanchep region; and
- › \$40.1 million towards the Interagency Emergency Service Radio Network, including \$6.3 million in 2025-26, delivering upgrades to ensure the critical network between community safety agencies continues to be reliable and secure.



Transport and Major Infrastructure

Building accessible and sustainable communities requires efficient transport links and plentiful housing.

The 2025-26 State Budget commits \$10.7 billion of investment in transport infrastructure over the next four years spanning the breadth of road, rail, river and ports. This pipeline of works includes synergies with the WA Government's Made in WA initiative helping to rejuvenate local capabilities while strengthening supply chain resilience.

A selection of major infrastructure projects is listed below with further details in [Appendix 1](#).



Westport

Given WA's geographic isolation and trade-driven economy, WA's economic prosperity relies heavily on sea-borne trade. The Westport program will deliver a new port and associated infrastructure to support a new container terminal in Cockburn Sound.

Key projects currently in progress within the Westport program of works include:

- › \$122.7 million (jointly funded by the State and Commonwealth Governments) to define project scopes and designs, primarily for marine works, including the replacement of the Kwinana Bulk Terminal; and
- › \$92.4 million for road works including enhancements to Anketell Road, Roe Highway and the Kwinana Freeway to meet Westport logistical requirements.

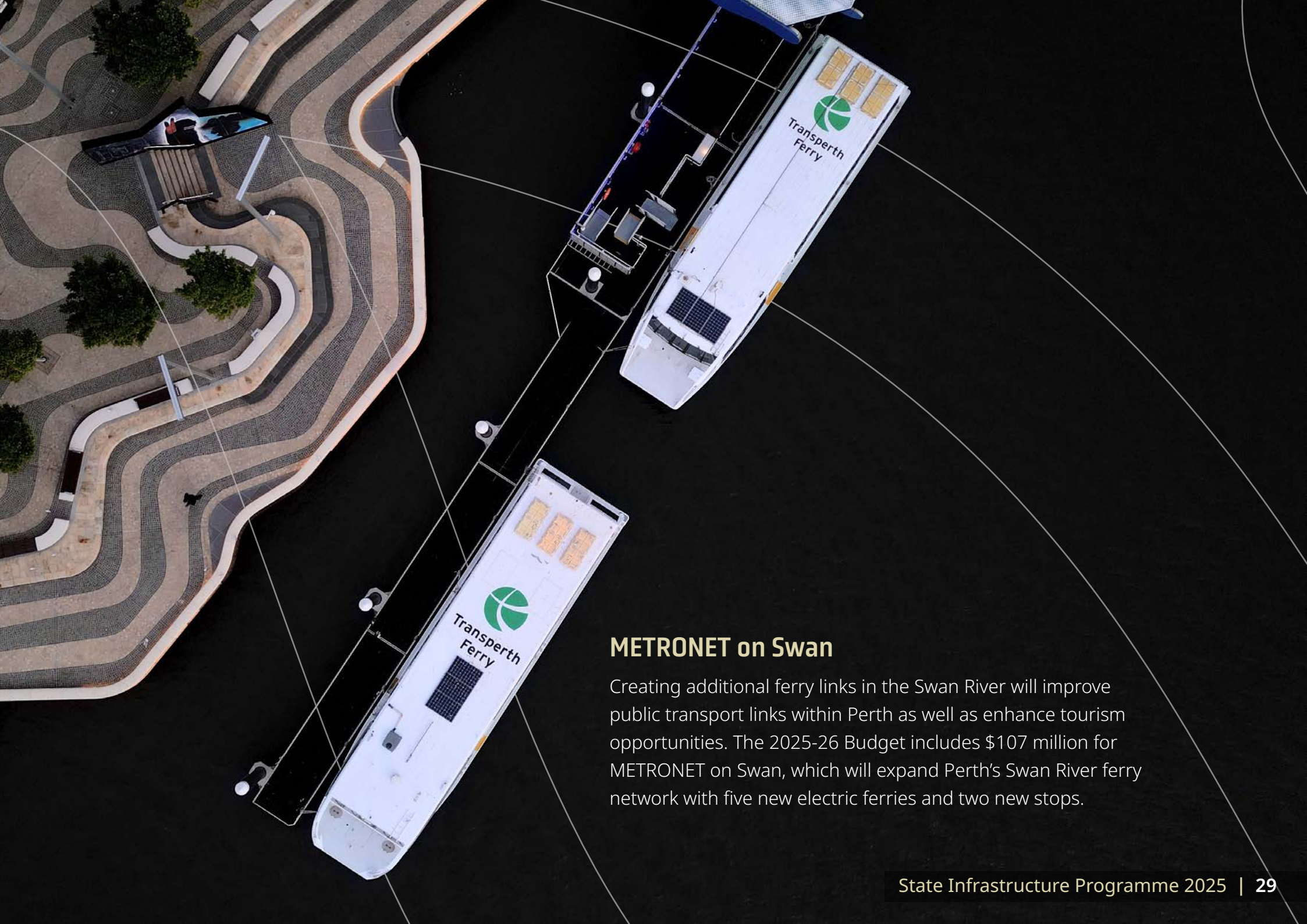

METRONET on Swan

Creating additional ferry links in the Swan River will improve public transport links within Perth as well as enhance tourism opportunities. The 2025-26 Budget includes \$107 million for METRONET on Swan, which will expand Perth's Swan River ferry network with five new electric ferries and two new stops.



Investment in Roads

Investment in WA's vast road network strengthens the State by improving safety, reducing travel times, and supporting economic growth. This provides better access to jobs, education, and services – laying the foundation for connected, resilient, and inclusive local economies.

Main Roads is forecast to spend \$5.5 billion over the forward estimates on significant road and bridge infrastructure works. This includes:

- \$965 million for Tonkin Highway Corridor Upgrades to increase the number of lanes from four to six, various grade separations, and delivery of the North Ellenbrook Interchange;
- \$295.3 million towards works on Reid Highway, including \$274 million for grade separations, and \$21.3 million for interchange works in West Swan;

- 
- An aerial photograph of the Perth Entertainment and Sporting Precinct. In the foreground, the large, modern Optus Stadium is visible, featuring a white, translucent, tent-like roof structure. The stadium's seating bowl is partially filled with spectators. Beyond the stadium, a lush green park area with winding paths and trees stretches towards the city. In the background, the Perth city skyline is visible, including several high-rise buildings. To the right, a large body of water, likely the Swan River, is visible, with a bridge crossing it in the distance. The sky is clear and blue.
- › \$213.5 million in 2025-26 to 2026-27 for works associated with the Perth Entertainment and Sporting Precinct to strengthen connections between Optus Stadium, Perth City and surrounds; and

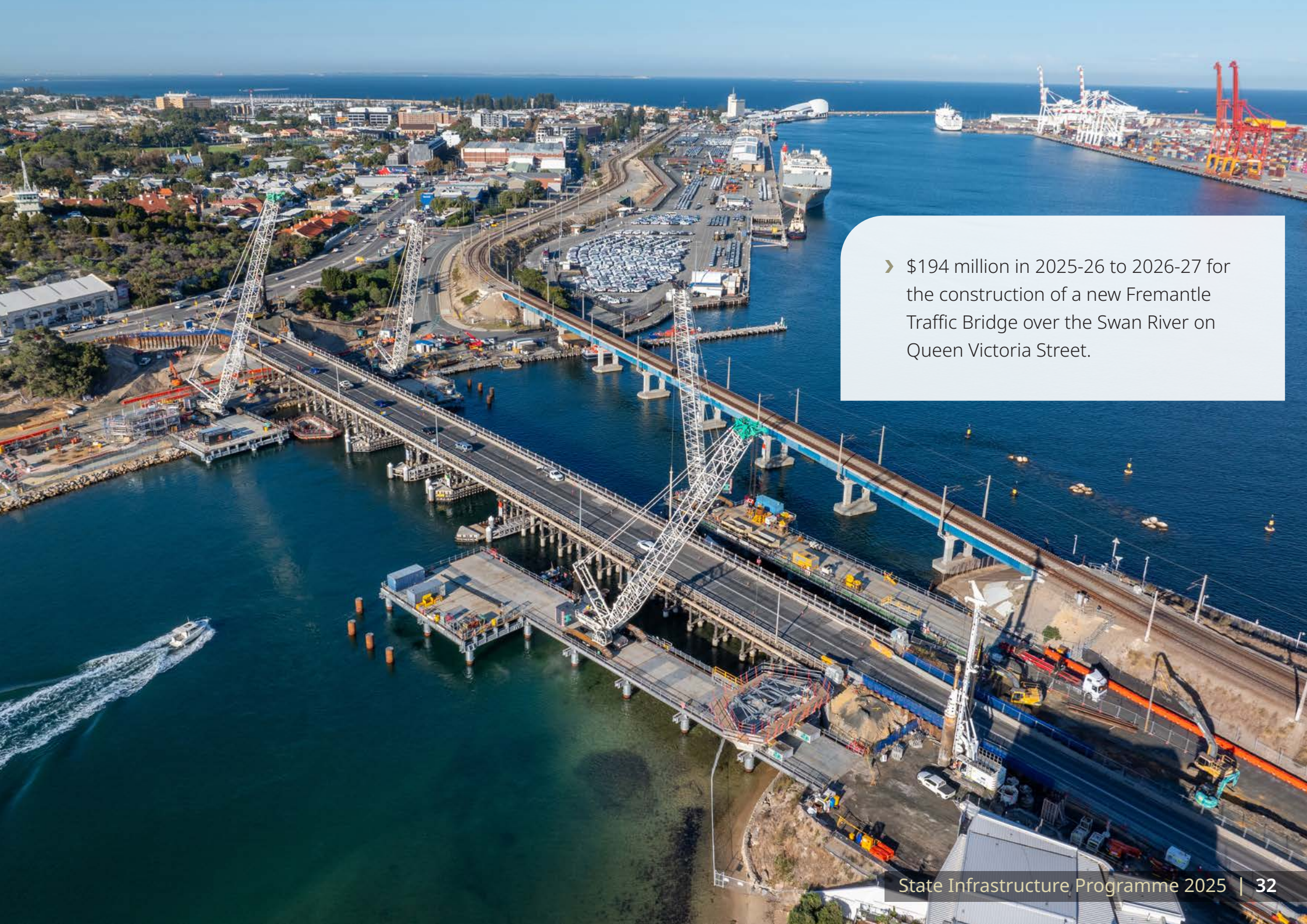

- \$194 million in 2025-26 to 2026-27 for the construction of a new Fremantle Traffic Bridge over the Swan River on Queen Victoria Street.

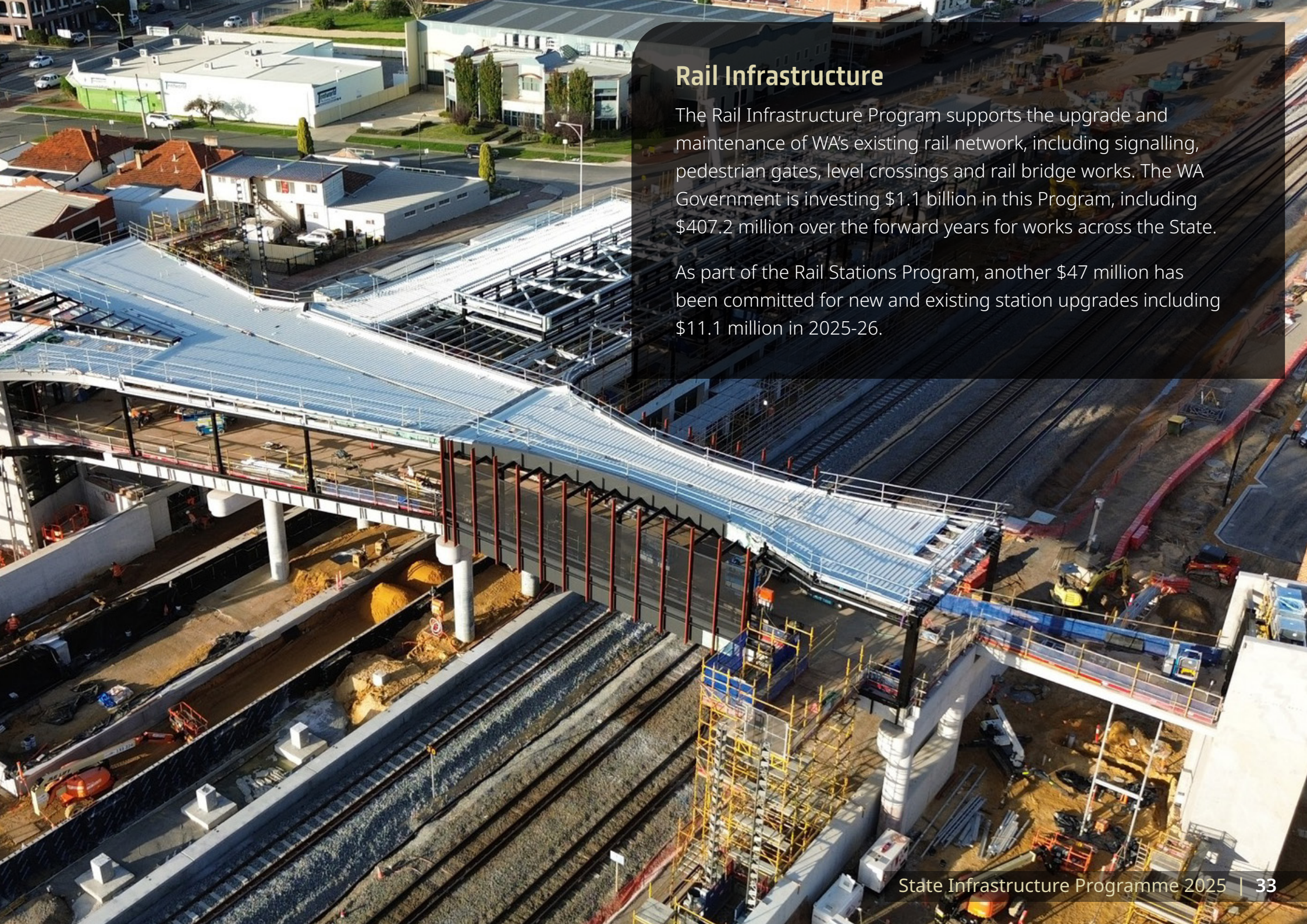

Rail Infrastructure

The Rail Infrastructure Program supports the upgrade and maintenance of WA's existing rail network, including signalling, pedestrian gates, level crossings and rail bridge works. The WA Government is investing \$1.1 billion in this Program, including \$407.2 million over the forward years for works across the State.

As part of the Rail Stations Program, another \$47 million has been committed for new and existing station upgrades including \$11.1 million in 2025-26.



Electric Buses (e-Buses)

Electric buses are a smart investment for modern transport systems. Benefits include reduced emissions, less maintenance, and more liveable cities through cleaner air and quieter streets.

Through the Made in WA plan, the State has also committed to make 130 electric buses locally. In support of this, the Government is investing \$435.3 million for e-buses, charging infrastructure and other depot modifications. The first stage of upgrade works to accommodate e-buses are focussed on the Malaga, Karrinyup, Bayswater and Claisebrook bus depots.

WA Agricultural Supply Chain Improvements

The Government is investing \$177.2 million on the Agricultural Supply Chain Improvements program. This program will increase freight capacities along key agricultural transport routes in the Wheatbelt, Great Southern, Mid West and Goldfields-Esperance regions.

Regional Road Safety

Main Roads' \$992.6 million Regional Road Safety Program is contributing to a reduction in the number of people killed and seriously injured on regional highways and roads. Main Roads will invest \$112.9 million in the Program between 2025-26 and 2026-27 for the sealing of shoulders and installation of audible edge lines, which are proven treatments to reduce single vehicle run off road crashes.

Main Roads' \$34 million Regional Level Crossing Upgrade will also see a further \$25.6 million invested into regional road safety over the forward estimates period.





Port Authorities

The AIP includes investment in port infrastructure totalling \$1.7 billion over the next four years.

Fremantle Port Authority

The Fremantle Port Authority's AIP for 2025-26 to 2028-29 totals \$360 million, covering the Inner Harbour in Fremantle and the Outer Harbour located in Cockburn Sound.

Key investments over the forward estimates include:

- › \$31.8 million for deck strengthening at Berths F and G at Victoria Quay and protective fenders to help prevent damage to the berths during mooring;
- › \$30 million to revitalise B-Shed on Victoria Quay, including construction of a new Rottnest Island ferry terminal and visitor centre; and
- › \$20.3 million to create a new tug facility at J Berth which will provide the home and services for the fleet of tugs that manage shipping across the port.



Kimberley Ports Authority

The Kimberley Ports Authority is positioning itself to capitalise on the region's developing resources sector. Its AIP for 2025-26 to 2028-29 totals \$43.7 million and includes \$14 million between 2025-26 and 2026-27 for the construction of inspection and washdown facilities at the Port of Wyndham to support direct imports of international containers and general cargo.



Mid West Ports Authority

The Mid West Ports Authority's AIP over the forward estimates totals \$391.1 million and includes:

- › \$306.5 million over 2025-26 to 2028-29 for the Geraldton Port Maximisation Project; and
- › \$23.4 million over 2025-26 to 2027-28 on a port-wide firefighting system to provide fully compliant fire systems across the Port of Geraldton.

Pilbara Ports Authority

The Authority's AIP totals \$727.9 million over the forward estimates period. This includes:

- › \$309.8 million between 2025-26 and 2026-27 for delivery of the Lumsden Point General Cargo Facility and Logistics Hub;
- › \$58.7 million in 2025-26 for the Port of Dampier's Bulk Handling Facility; and
- › \$14.4 million between 2025-26 and 2026-27 to support the future development of the Port of Ashburton's multi-user facilities.

Southern Ports Authority

The Southern Ports Authority's AIP over the forward estimates totals \$165.1 million. This includes \$87.7 million for sustaining capital works across the three ports (Albany, Bunbury and Esperance) to maintain current port capacity and sustain its asset base.

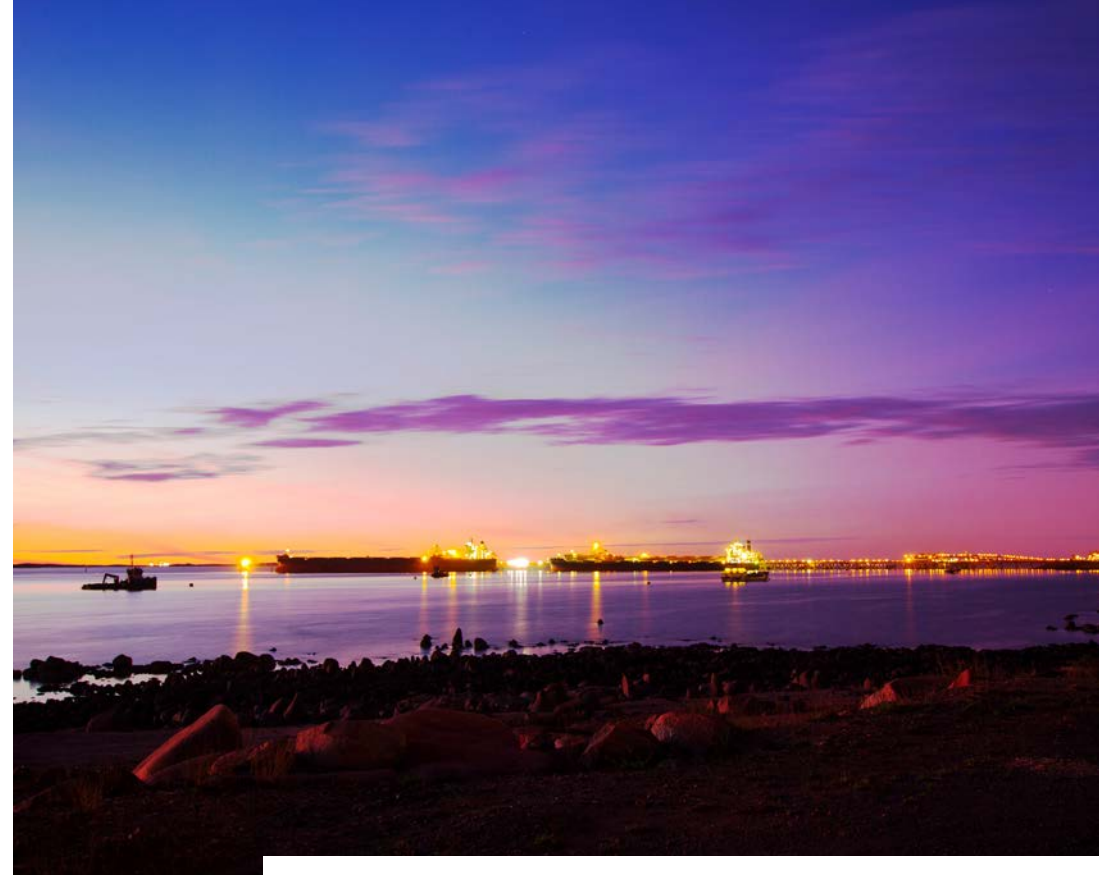



Housing

Housing is critical to WA's liveability, supporting population growth, workforce stability, and community wellbeing. It underpins economic development, attracts investment, and ensures people can live affordably near jobs and services.

The Government is delivering a program of over 5,800 social homes, with more than 3,000 homes already complete, and a further 1,000 homes under construction or contract. Additionally, since 1 July 2020, over 2,000 refurbishments have been completed with maintenance conducted on many thousands more.

Significant investments in housing include:

- › \$1.6 billion of investment into New Social Housing which includes \$557.6 million over the forward estimates period;
- › \$438.4 million for the Government Regional Officer Housing Program to help accommodate public sector employees such as teachers, police and health workers residing or relocating to regional areas;
- › \$151.8 million for the METRONET Social and Affordable Housing and Jobs Package investing in housing which helps build liveable and connected communities while supporting infill density targets;
- › \$138.2 million for the Housing and Homelessness Investment Package comprising \$48.7 million for Common Ground - Mandurah and \$89.5 million for Common Ground - Perth; and
- › \$75.7 million for Aboriginal Short Stay Accommodation in the East Kimberley, Geraldton and Perth.

In addition, the Department of Primary Industries and Regional Development's AIP includes \$15.7 million over the forward estimates period for the North West Aboriginal Housing Initiative which creates pathways towards socio-economic independence and wellbeing in the Pilbara and Kimberley.





Environment

Western Australia's distinct biodiversity, along with its abundant lands, waters, and attractions, are vital to the cultural, environmental, and economic wellbeing of communities throughout the State.

By investing in environmental infrastructure, the WA Government is playing a crucial role in protecting and restoring natural habitats. These efforts not only safeguard WA's unique biodiversity, but also bolster economic resilience and promote sustainable development, ensuring that the natural beauty and resources of the State are preserved for future generations.

Key Government investments include:

- › \$111.5 million for Plan for Our Parks, which will create a minimum of five million hectares of new national parks, marine parks and conservation reserves, protecting natural assets and opening opportunities for nature-based and cultural tourism;
- › \$41.1 million for upgrades and works across Karijini, Murujuga, Torndirrup, Wellington and William Bay National Parks, including \$6.4 million between 2025-26 and 2027-28 towards upgrades to the Wellington Dam Kiosk and William Bay National Park; and
- › \$36.3 million for the Environment Online digital platform, enabling more streamlined processes for environmental and water regulation across the State, with works progressing to finalise the platform.



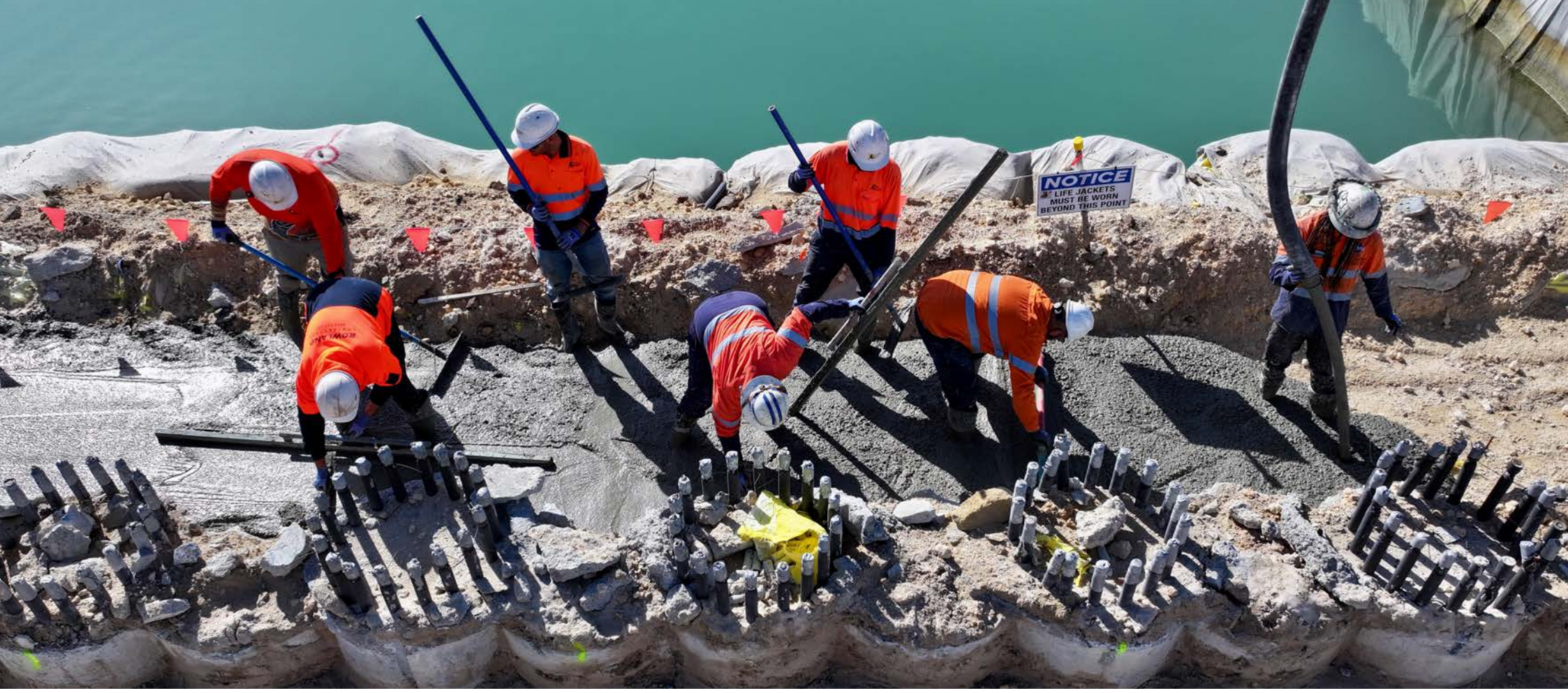

Planning and Land Use

Strategic planning and land use are essential to WA's growth – effectively guiding infrastructure delivery and environmental outcomes. The WA Government has invested in several significant projects that support effective planning and land use.

Western Australian Planning Commission

The Commission's AIP totals \$192.2 million from 2025-26 to 2028-29 and includes the acquisition of land reserved under the Metropolitan, Peel and Greater Bunbury Region Schemes and development of facilities on reserved land, along with land acquisitions for transport infrastructure.



DevelopmentWA

DevelopmentWA's AIP totals \$2.1 billion over the next four years, with \$980.7 million to be spent in 2025-26 on new and continuing works.

The AIP will enable the delivery of land for housing (including social, affordable and community homes), business and for infrastructure to support WA communities, including:

- › \$685.2 million for land development as part of the Metropolitan Program, including \$269.7 million for the Ocean Reef Marina, \$176.8 million for Alkimos Central and \$146.1 million for the Subi East Precinct to further enhance liveability;



- › \$652.8 million over the forward estimates for land development under the Residential Program, including \$397.8 million for Industry and Infrastructure Acquisition and Development, \$112.9 million for the Pier Street Residential Development and \$103.8 million for the Fremantle Burt Street Residential Development;
- › \$287.9 million of State Government investment in Housing Australia Future Fund projects to support social and affordable housing and other acute housing needs in the metropolitan area;

- › \$225.3 million for the Industrial Lands Authority Program, including \$25.2 million for the Neerabup Australian Automation and Robotics Park and \$151.9 million for new works to support major industrial development on the Western Trade Coast; and
- › \$81.1 million for land development under the Regional Program including \$65.9 million for the Karratha Madigan Road and \$15.2 million for the Nyamba Buru Yawuru – Health and Wellbeing Campus.





Water

Water is an essential resource for WA's economy, environment and communities. As WA faces increasing water supply challenges – including from climate change, population growth, and industrial demand – the availability of affordable and suitable water sources will be crucial to maintaining our way of life.

The Water Corporation's AIP commits \$2.2 billion in 2025-26 to water infrastructure projects across the State.

Significant investments include:

- › \$992.9 million in 2025-26 towards the Alkimos Seawater Desalination Plant (ASDP) program of works, with Stage One expected to contribute 50 billion litres of drinking water per year to the metropolitan water supply;
- › \$313 million in 2025-26 to wastewater treatment and network projects in both the northern and southern metropolitan corridors, including the \$55.7 million expansion of the Kwinana Water Reclamation Plant and the \$45.3 million upgrade of the Woodman Point Water Resource Recovery Facility; and
- › \$498 million in 2025-26 for regional water infrastructure including:
 - \$235.1 million towards a major upgrade of the Goldfields and Agricultural Water Supply Scheme to deliver an additional 7.2 megalitres of water daily to communities and key industries;
 - \$66.6 million towards upgrading the capacity of the Burrup Seawater Supply Scheme to enable supply to Perdaman's urea project underpinning a secure local supply of fertiliser; and
 - \$52.2 million towards the construction of a water treatment plant in Onslow, which will have the capacity to provide up to 1.5 million litres of drinking water per day to the Onslow community.



A large-scale construction project is underway at dusk. A tall concrete pump truck is positioned in the center, pouring concrete into a large, circular, precast structure. Several workers in high-visibility vests are standing on the structure, which is covered in a dense grid of rebar. In the background, two concrete mixer trucks and other vehicles are parked on a dirt road. The sky is a mix of orange, pink, and blue, indicating sunset. The overall scene is one of active infrastructure development.

Energy

Investments in our electricity infrastructure are critical to maintaining current capacity, accommodating new demand, and progressing our State's decarbonisation and energy transition.

The State's electricity corporations (Western Power, Synergy and Horizon Power) will spend an estimated \$7 billion from 2025-26 to 2028-29, with major investments including:

- › \$623.9 million over the forward estimates to deliver key renewable assets comprising \$199.9 million to complete the Collie Battery Energy Storage System and \$424 million for the Kings Rock Wind Farm;
- › \$542 million in 2025-26 to continue to progress the Clean Energy Link – North project, to upgrade transmission lines to allow new wind capacity connections in the Wheatbelt and Mid West, and other works to support decarbonisation of the South West Interconnected System; and
- › \$112.2 million in 2025-26 and a further \$237.7 million over the outyears to enhance safe and reliable electricity supply in the regions, including in Exmouth and Leonora.



CHAPTER 3

INFRASTRUCTURE OUTLOOK





Western Australia is experiencing robust population growth. As the State evolves, so too will its infrastructure needs and pressures. The path ahead will be shaped by the energy transition, new industries, technological innovation, and changing community aspirations.

This chapter provides an overview of the significant infrastructure needs and challenges that will impact Western Australia over the next decade, and some of the steps the WA Government has already taken to address them.



Demographic changes

The Australian Bureau of Statistics notes that WA's population surpassed 3 million in late 2024 and has become the fastest-growing state in the country. Growth is driven by strong net overseas migration, particularly into Perth.

WA's population is becoming more culturally diverse and more urbanised, with increasing demand for housing, infrastructure, and services. Regional areas are also experiencing change, shaped by industry shifts and workforce mobility.

Like most advanced economies, low fertility rates and increasing life expectancy are driving WA's ageing population. These changes will impact the infrastructure Western Australia needs, with growing demand for new housing, transport and healthcare solutions. They will also impact the availability of skilled workers to build new infrastructure.



Workforce

Equipping Western Australia's workforce with the skills required for the future is a vital and ongoing priority. Over the next decade, the State will continue to act to ensure individuals, industries, and communities are prepared to thrive in a rapidly evolving economic, technological, and environmental landscape.

With much of the developed world currently facing shortages in skilled labour, investment in our workforce will remain critical to ensure WA is well-positioned to deliver the infrastructure needed to support our emerging industries and the growing community.

The WA Government is working to uplift the State's labour force by investing in our pipeline of skilled local workers. Measures include:

- › \$21.9 million in the 2025-26 Budget to make additional building and construction courses fee-free in 2026, 2027 and 2028;
- › \$27 million to provide an additional 225 places in the Group Training Organisation Wage Subsidy Program to support employers and apprentices in the construction sector, and \$14.6 million to the Adult Apprentice Incentive Program for 400 places to employ mature-aged apprentices in building and construction; and
- › \$11.5 million over the forward estimates to establish the AUKUS Defence Industry Incentive Scheme to grow Western Australia's AUKUS defence workforce.

Housing

Western Australia's strong economy and desirable lifestyle continue to attract new residents, driving sustained population growth and increasing demand for housing and other enabling infrastructure. Whilst data from the Real Estate Institute of WA reflects a positive shift with Perth's rental vacancy rate improving from 0.4% in early 2024 to 2.8% as of May 2025, ongoing commitment to delivering housing will remain essential in addressing supply constraints.

The WA Government is responding to these challenges, investing in a pipeline of new and affordable housing supply. With \$5.8 billion invested into housing and homelessness initiatives since 2021, additional key initiatives include:

- › \$1.3 billion over the forward estimates to address homelessness, and improve public housing and crisis accommodation across WA, including through new Common Ground Facilities, the Social and Affordable Housing Investment Fund, and Short Stay Accommodation Facilities; and
- › \$438.4 million for the Government Regional Officer Housing Program to help accommodate employees such as teachers, police and health workers residing or relocating to regional areas.

The Government's Housing Supply Unit within the Department of Treasury and Finance will continue to collaborate with industry and community housing providers to help ensure there is sufficient land and housing supply over the coming years.





Transport

WA's transport network plays a significant role in connecting communities, critical services and business to markets. As the State's population and industry continue to expand, the breadth and efficiency of our transport infrastructure will remain a key determinant of WA's ability to support economic growth, productivity and community wellbeing.

Despite much of METRONET having now been delivered, including the recent opening of the new Ellenbrook Line and the Thornlie-Cockburn Line, notable expansion of the public transport network will continue. Greater use of Perth's river network through METRONET on Swan will provide opportunities to enhance accessibility to key education and employment hubs within Perth. The project will also support priorities such as urban development and growth in our green infrastructure through electrification of Perth's ferry network.



Additional initiatives designed to prepare WA for the future include:

- › \$707.5 million over the forward estimates to widen and upgrade the Kwinana Freeway, helping to ease congestion including to support future economic activity connected to the Western Trade Coast;
- › \$25 million from 2026-27 to 2028-29 to improve the South Coast Highway, a key freight and tourism route stretching from Esperance to Walpole; and
- › \$25 million from 2025-26 to 2026-27 for the Northam-Pithara Road to realign sections of the road and replace ageing bridges.

With 90% of the world's goods trade occurring via maritime transport, strengthening transport networks and access to ports is crucial for connecting WA businesses to interstate and global markets. To ensure the State's port infrastructure meets future demand, the Government is progressing Westport – a new container port in Cockburn Sound – with a preferred design announced and detailed planning underway. The 2025–26 Budget also commits \$744.1 million to upgrade other key port assets, including the Lumsden Point General Cargo Facility and Logistics Hub in the Pilbara.



Economic development

Ensuring WA can respond to increasing uncertainty in the global economy will require careful consideration and proactive planning. Geopolitical tensions, climate change and economic fluctuations can impact WA's prosperity now and into the future.

WA's economy has strong foundations – with abundant natural resources, stable institutions, a skilled workforce, good infrastructure and strong links to major trading partners. This position is further strengthened by the State's strong credit rating, being the only Australian state to hold a AAA credit rating from the two major agencies, S&P Global and Moody's.

The Government is investing to ensure the State's healthy economic position continues. As part of the 2025-26 Budget, the Government invested \$1.4 billion to make WA's economy more resilient.

This investment included:

- › a \$500 million expansion of the Strategic Industries Fund (taking the total contribution to \$1 billion), which will help unlock industrial land across WA;
- › \$209.4 million to boost local manufacturing of buses, batteries and ferries; and
- › \$38.5 million to support the defence, mining and exploration, and hospitality sectors.

Energy transition

The world is undergoing significant transformation, driven by climate change and the global shift toward decarbonisation. These forces are reshaping infrastructure needs everywhere – including in Western Australia. As industry and government move toward a net zero future, demand for renewable energy, clean transport, and expanded transmission networks will increase demand for skilled labour, materials, and specialised expertise.

WA's energy transition is already well underway. The Government has invested \$1.4 billion into decarbonisation initiatives in 2025-26, spanning utilities, ferry and bus electrification, and other new energy initiatives – bringing total investment since 2017 to \$6.4 billion. These investments will accelerate WA's renewable energy generation and extend network capacity to meet rising demand. This includes \$584 million over the forward estimates to unlock wind generation north of Perth and to expand renewable energy generation, enabling closure of coal-fired power stations by 2030.



Emerging technologies

As the digital landscape continues to evolve rapidly, technological transformation is fast driving change to economies and communities across the world. Ensuring our infrastructure is built for a digital future will be critical in navigating mass digitisation and positioning WA to respond to emerging opportunities and threats.

The Government is supporting the uptake of new technologies with the WA: Digitally Evolved Digital Industries Acceleration Strategy, which aims to empower the digital capabilities of industry and businesses across the State. It is also expanding fee-free TAFE courses, which will assist in the development of a future digital-ready workforce.

Ensuring regional businesses and communities stay connected and responsive to new technological developments will be a critical infrastructure consideration across the next decade. Current initiatives including the Regional Telecommunications Project, Regional Digital Connectivity Program, and State Agriculture Telecommunications Infrastructure Fund will work to strengthen regional connectivity.



Future trends and initiatives

The WA Government continues to make strategic, long-term infrastructure investments to position the State for the future. From transport and energy to ports and essential services, these projects are designed to strengthen communities, support economic development, and drive prosperity across Western Australia.

Looking ahead, the Government will continue to monitor evolving trends that shape our society – whether demographic shifts, workforce dynamics, technological change or environmental challenges. Recognising these changes will play out over decades, the Government will continue to plan proactively and adaptively, ensuring WA's infrastructure meets our future needs and unlocks the opportunities ahead.

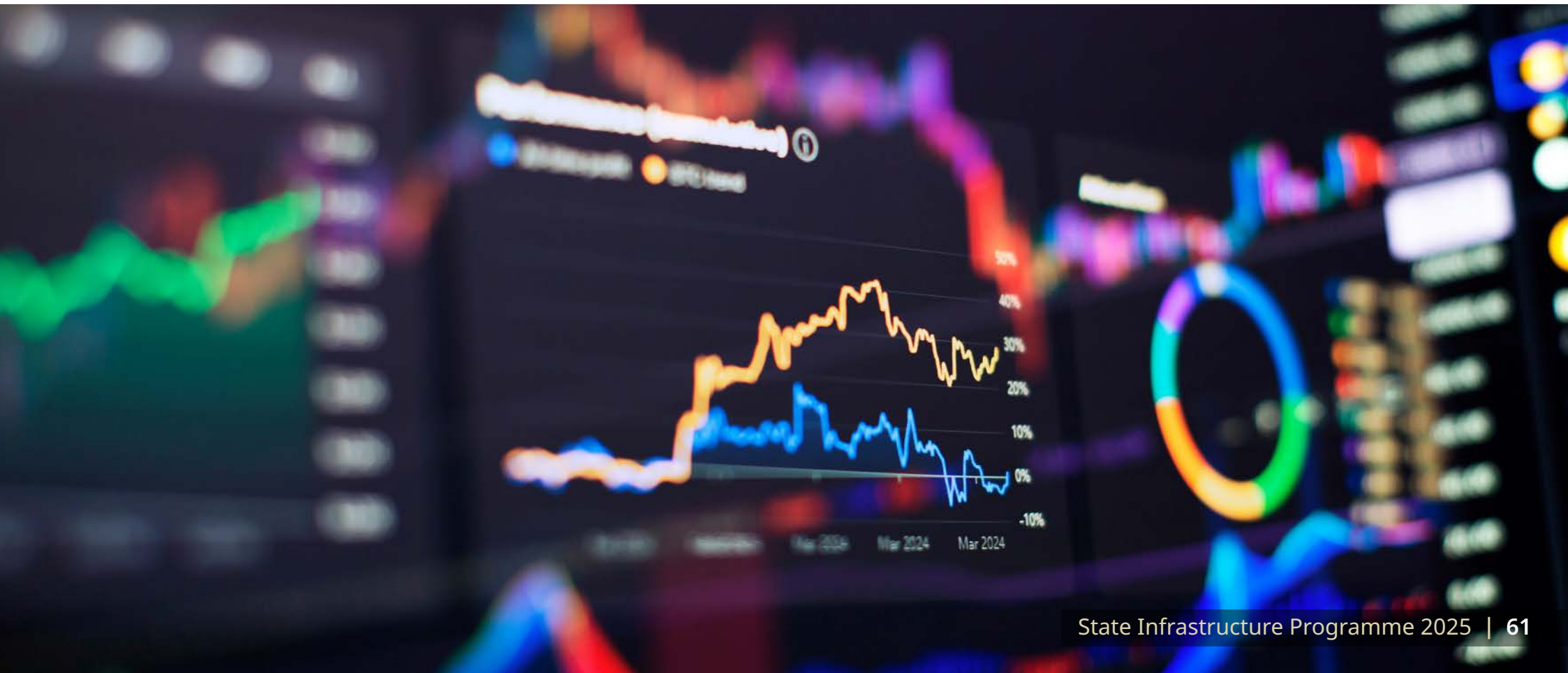



FIND OUT MORE



Additional information on opportunities for businesses and the wider community can be found through:

Tenders WA

Tenders WA is the central source of information on WA public sector requests for tender and awarded contracts. WA Government departments and agencies use this website to advertise their public requests and early tender advice, as well as publish awarded contracts.

WA Industry Link

The WA Government purchases a variety of goods, services, works and community services from business each year. Industry Link is a high-level summary of anticipated upcoming procurements to assist industry to identify opportunities.

Market-Led Proposals

The Market-Led Proposals process enables the private sector to submit unique proposals for Government's consideration. It provides an innovative opportunity for Government and the private sector to work together, create jobs and stimulate the Western Australian economy.

Pipeline of Works

The Pipeline is a listing of current and future infrastructure projects. It helps Western Australian businesses to better plan for major WA Government tenders, sustaining companies across the State and creating local jobs.



APPENDIX 1: LIST OF SIGNIFICANT INFRASTRUCTURE COMMITMENTS

This appendix provides a list of Government infrastructure commitments over \$20 million.

Jobs and Economic Development

Project name	Responsible organisation	Region	Estimated Total Cost (\$m)	Entire Project Period
Facilities and Infrastructure - New Metropolitan Facility	Primary Industries and Regional Development	PERTH METRO	320	2021-22 to 2030-31
Perth Film Studios	Creative Industries, Tourism and Sport	PERTH METRO	233	2021-22 to 2028-29
Softwood Plantation Expansion Program - Softwood Plantation Investment Program	Forest Products Commission	SOUTH WEST	224	2022-23 to 2028-29
Plant and Equipment Replacement Program	Gold Corporation	PERTH METRO	196	2012-13 to 2028-29
Australian Hockey Centre	Creative Industries, Tourism and Sport	PERTH METRO	163	2023-24 to 2027-28
Perth Concert Hall Redevelopment	Creative Industries, Tourism and Sport	PERTH METRO	150	2020-21 to 2028-29
Wagering Systems and Products	Racing and Wagering WA	PERTH METRO	103	2012-13 to 2028-29
Facilities and Infrastructure - State Biosecurity Response Centre	Primary Industries and Regional Development	PERTH METRO	100	2024-25 to 2025-26
Plant and Equipment Investment and Replacement	Primary Industries and Regional Development	PERTH METRO	66	2012-13 to 2028-29

Project name	Responsible organisation	Region	Estimated Total Cost (\$m)	Entire Project Period
Pilbara Hydrogen Hub	Primary Industries and Regional Development	PILBARA	64	2022-23 to 2027-28
Optus Stadium - Capital Works - Optus Stadium - DBFM Lifecycle and Modifications	WA Sports Centre Trust (VenuesWest)	PERTH METRO	58	2017-18 to 2028-29
Primary Industries Development Research Facility	Primary Industries and Regional Development	PERTH METRO	56	2025-26 to 2025-26
Perth Cultural Centre	Creative Industries, Tourism and Sport	PERTH METRO	55	2021-22 to 2027-28
Aboriginal Cultural Centre	Creative Industries, Tourism and Sport	PERTH METRO	50	2023-24 to 2029-30
Racing Systems, Infrastructure and Minor Capital	Racing and Wagering WA	PERTH METRO	46	2017-18 to 2028-29
HBF Park - Stadium Modifications to Host WWC 2023	WA Sports Centre Trust (VenuesWest)	PERTH METRO	42	2021-22 to 2025-26
Malaga Sports Precinct	Creative Industries, Tourism and Sport	PERTH METRO	20	2025-26 to 2028-29

Health

Project name	Responsible organisation	Region	Estimated Total Cost (\$m)	Entire Project Period
New Women and Babies Hospital Project	WA Health	PERTH METRO	1,782	2022-23 to 2029-30
Equipment - Medical Equipment and Imaging Replacement Program	WA Health	STATE-WIDE	749	2014-15 to 2026-27
Bunbury Hospital Redevelopment	WA Health	SOUTH WEST	471	2019-20 to 2028-29
Joondalup Health Campus Development Stage 2	WA Health	PERTH METRO	297	2017-18 to 2025-26
Minor Building Works Program	WA Health	STATE-WIDE	205	2004-05 to 2025-26
Geraldton Health Campus Redevelopment	WA Health	MID WEST	190	2017-18 to 2027-28
Graylands Reconfiguration and Forensics Project	WA Health	PERTH METRO	186	2025-26 to 2028-29
Bentley Health Service - Surgicentre	WA Health	PERTH METRO	167	2024-25 to 2028-29
Peel Health Campus - Redevelopment	WA Health	PEEL	143	2023-24 to 2028-29
Busselton Health Campus	WA Health	SOUTH WEST	115	2006-07 to 2025-26
St John of God Midland - Public Hospital Expansion	WA Health	PERTH METRO	80	2025-26 to 2026-27

Project name	Responsible organisation	Region	Estimated Total Cost (\$m)	Entire Project Period
Fremantle Mental Health Beds	WA Health	PERTH METRO	65	2020-21 to 2025-26
Newman Health Service Redevelopment Project	WA Health	PILBARA	63	2015-16 to 2025-26
Laverton Hospital	WA Health	GOLDFIELDS-ESPERANCE	62	2019-20 to 2026-27
Bentley Health Service – Secure Extended Care Unit	WA Health	PERTH METRO	56	2021-22 to 2028-29
Renal Dialysis and Support Services	WA Health	REGIONAL - ALL	49	2013-14 to 2026-27
Meekatharra Hospital	WA Health	MID WEST	49	2021-22 to 2027-28
Sir Charles Gairdner Hospital - Emergency Department Upgrade and Behavioural Assessment Urgent Care Centre	WA Health	PERTH METRO	49	2019-20 to 2027-28
Byford Health Hub	WA Health	PEEL	41	2022-23 to 2028-29
Sarich Neuroscience Research Institute Centre	WA Health	PERTH METRO	35	2015-16 to 2025-26
King Edward Memorial Hospital Critical Infrastructure	WA Health	PERTH METRO	34	2019-20 to 2026-27
Fiona Stanley Hospital – Cladding	WA Health	PERTH METRO	33	2025-26 to 2028-29

Project name	Responsible organisation	Region	Estimated Total Cost (\$m)	Entire Project Period
Tom Price Hospital Redevelopment	WA Health	PILBARA	33	2017-18 to 2026-27
Sir Charles Gairdner Hospital Intensive Care Unit (ICU)	WA Health	PERTH METRO	32	2022-23 to 2027-28
Primary Health Centres Demonstration Program	WA Health	REGIONAL - ALL	32	2013-14 to 2026-27
State-wide Cladding	WA Health	STATE-WIDE	28	2025-26 to 2027-28
Anti-Ligature Remediation Program - Statewide	WA Health	STATE-WIDE	28	2024-25 to 2026-27
Renal Dialysis Centre in Halls Creek	WA Health	KIMBERLEY	25	2022-23 to 2027-28
Royal Perth Hospital ICU	WA Health	PERTH METRO	25	2019-20 to 2025-26
Information and Communication Equipment and Infrastructure - State Health Operations Centre	WA Health	PERTH METRO	22	2023-24 to 2026-27
Fremantle Hospital - Safety, Fire Compliance and Critical Electrical Infrastructure	WA Health	PERTH METRO	22	2024-25 to 2027-28
Ward 5A Reconfiguration	WA Health	PERTH METRO	21	2023-24 to 2027-28
Critical Staff Accommodation	WA Health	REGIONAL - ALL	21	2022-23 to 2025-26

Education and Training

Project name	Responsible organisation	Region	Estimated Total Cost (\$m)	Entire Project Period
Small Asset Capital Purchases	Education	STATE-WIDE	669	2015-16 to 2028-29
New Primary Schools - New Primary Schools (2028-2031) (Locations to be Determined)	Education	STATE-WIDE	250	2024-25 to 2031-32
Transportable Classrooms	Education	STATE-WIDE	197	2014-15 to 2026-27
Remedial Works Program	Training and Workforce Development	STATE-WIDE	174	2013-14 to 2028-29
New Primary Schools - East Perth Primary School (Planning Name)	Education	PERTH METRO	168	2023-24 to 2029-30
2025 Election Commitments - Brabham Senior High School	Education	PERTH METRO	130	2023-24 to 2029-30
Roebourne District High School Expansion	Education	PILBARA	94	2020-21 to 2026-27
Land for Primary Schools	Education	STATE-WIDE	92	2015-16 to 2028-29
Additions and Improvements to Secondary Schools - Science, Technology, Engineering and Mathematics	Education	STATE-WIDE	89	2021-22 to 2026-27

Project name	Responsible organisation	Region	Estimated Total Cost (\$m)	Entire Project Period
Piara Waters Senior High School Stage 2	Education	PERTH METRO	73	2023-24 to 2028-29
New Secondary Schools - Piara Waters Senior High School	Education	PERTH METRO	60	2019-20 to 2025-26
Additions and Improvements to Secondary Schools - Rockingham Senior High School and Education Support Centre	Education	PERTH METRO	60	2023-24 to 2029-30
Plaster Glass Ceiling Replacement and Remediation	Education	STATE-WIDE	58	2020-21 to 2026-27
New Primary Schools - Piara Waters West Primary School (Planning Name)	Education	PERTH METRO	54	2024-25 to 2028-29
North Metropolitan TAFE Balga Campus - Specialist Teaching Block	Training and Workforce Development	PERTH METRO	51	2020-21 to 2026-27
New Primary Schools - Banksia Grove West Primary School (Planning Name)	Education	PERTH METRO	51	2024-25 to 2028-29
John Forrest Secondary College - Redevelopment	Education	PERTH METRO	51	2018-19 to 2025-26
New Primary Schools - Alkimos North East Primary School (Planning Name)	Education	PERTH METRO	46	2024-25 to 2028-29

Project name	Responsible organisation	Region	Estimated Total Cost (\$m)	Entire Project Period
North Regional TAFE - Pundulmurra Trade Expansion (South Hedland)	Training and Workforce Development	PILBARA	44	2020-21 to 2025-26
Additions and Improvements to Secondary Schools - Rossmoyne Senior High School	Education	PERTH METRO	44	2021-22 to 2026-27
Investing in Modern Equipment for TAFEs	Training and Workforce Development	STATE-WIDE	43	2021-22 to 2028-29
2025 Election Commitments - Cool the Schools (Tranche 1)	Education	STATE-WIDE	43	2025-26 to 2027-28
Additions and Improvements to Secondary Schools - Duncraig Senior High School	Education	PERTH METRO	43	2021-22 to 2025-26
2025 Election Commitments - New Schools & Maintenance Vision - Minor Upgrades (Tranche 1)	Education	STATE-WIDE	42	2025-26 to 2026-27
New Primary Schools - Wungong Primary School (Planning Name)	Education	PERTH METRO	41	2023-24 to 2027-28
New Primary Schools - Eglinton Beach Primary School	Education	PERTH METRO	40	2022-23 to 2026-27
Additions and Improvements to Secondary Schools - Safety Bay Senior High School	Education	PERTH METRO	40	2023-24 to 2029-30

Project name	Responsible organisation	Region	Estimated Total Cost (\$m)	Entire Project Period
Infrastructure Power Upgrades	Education	STATE-WIDE	39	2016-17 to 2029-30
South Metropolitan TAFE - Armadale Training Campus	Training and Workforce Development	PERTH METRO	39	2020-21 to 2025-26
Additions and Improvements to Secondary Schools - Kalamunda Senior High School	Education	PERTH METRO	38	2020-21 to 2025-26
Additions and Improvements to Secondary Schools - Ashdale Secondary College	Education	PERTH METRO	38	2022-23 to 2028-29
New Primary Schools - Maarakool Primary School	Education	PERTH METRO	38	2022-23 to 2026-27
New Primary Schools - Wellard Village Primary School	Education	PERTH METRO	38	2019-20 to 2025-26
Brabham Primary School - Additional Accommodation including Education Support Centre	Education	PERTH METRO	37	2022-23 to 2027-28
Land Acquisition - General	Education	STATE-WIDE	37	2019-20 to 2025-26
Air Conditioning Replacement Program	Education	STATE-WIDE	37	2015-16 to 2028-29
Clean Energy Skills National Centre of Excellence Renewables Training Equipment	Training and Workforce Development	STATE-WIDE	37	2025-26 to 2027-28

Project name	Responsible organisation	Region	Estimated Total Cost (\$m)	Entire Project Period
Roof Replacements	Education	STATE-WIDE	36	2019-20 to 2025-26
New Primary Schools - Wellard East Primary School (Planning Name)	Education	PERTH METRO	36	2023-24 to 2026-27
Schools Clean Energy Program	Education	STATE-WIDE	35	2021-22 to 2025-26
Fire Services Upgrade	Education	PERTH METRO	34	2016-17 to 2027-28
Asset Replacement Program	South Metropolitan TAFE	PERTH METRO	32	2016-17 to 2028-29
Additions and Improvements to Secondary Schools - Karratha Senior High School	Education	PILBARA	31	2020-21 to 2025-26
New Primary Schools - Henley Brook Primary School	Education	PERTH METRO	28	2021-22 to 2025-26
Additions and Improvements to Secondary Schools - Derby District High School	Education	KIMBERLEY	28	2020-21 to 2026-27
Additions and Improvements to Secondary Schools - John Curtin College of the Arts	Education	PERTH METRO	27	2021-22 to 2026-27
Commonwealth's Schools Upgrade Fund	Education	STATE-WIDE	27	2023-24 to 2027-28

Project name	Responsible organisation	Region	Estimated Total Cost (\$m)	Entire Project Period
Caversham Primary School - Additional Accommodation	Education	PERTH METRO	26	2023-24 to 2028-29
New Primary Schools - Madora Bay Primary School	Education	PEEL	26	2020-21 to 2025-26
New Primary Schools - Jilbup Primary School	Education	PERTH METRO	25	2021-22 to 2025-26
Harrisdale Primary School - Additional Accommodation	Education	PERTH METRO	25	2022-23 to 2027-28
Asset Replacement Program	North Metropolitan TAFE	PERTH METRO	24	2012-13 to 2028-29
Byford Secondary College Stage 4	Education	PEEL	23	2022-23 to 2026-27
New Primary Schools - Hillarys Primary School (Rebuild)	Education	PERTH METRO	23	2020-21 to 2025-26
South Regional TAFE - Albany Trade Workshop	Training and Workforce Development	GREAT SOUTHERN	22	2020-21 to 2025-26
Mount Hawthorn Education Support Centre relocation to Lake Monger Primary	Education	PERTH METRO	22	2024-25 to 2028-29

Community Safety

Project name	Responsible organisation	Region	Estimated Total Cost (\$m)	Entire Project Period
Casuarina Prison Expansion - Stage 2	Justice	PERTH METRO	254	2018-19 to 2026-27
Fremantle District Police Complex	Western Australia Police Force	PERTH METRO	140	2020-21 to 2028-29
Custodial - Building Upgrades and Replacement	Justice	STATE-WIDE	104	2013-14 to 2028-29
Urgent Minor Works Facilities Modifications	Fire and Emergency Services	STATE-WIDE	92	2014-15 to 2028-29
Armadale Courthouse and Police Complex	Western Australia Police Force	PERTH METRO	84	2012-13 to 2025-26
Banksia Hill Detention Centre (BHDC)	Justice	PERTH METRO	71	2021-22 to 2025-26
Building Infrastructure and Maintenance - Adult Facilities	Justice	STATE-WIDE	67	2013-14 to 2028-29
Equipment Replacement Program	Fire and Emergency Services	STATE-WIDE	42	2013-14 to 2028-29
Emergency Services Radio Network Tranche 1	Western Australia Police Force	STATE-WIDE	40	2021-22 to 2025-26
Police Facilities Upgrade Program 2024-2028	Western Australia Police Force	STATE-WIDE	35	2023-24 to 2028-29
Kimberley Floods Temporary Accommodation	Communities	KIMBERLEY	34	2023-24 to 2025-26

Project name	Responsible organisation	Region	Estimated Total Cost (\$m)	Entire Project Period
Asset Equipment Management Program 2024-2028	Western Australia Police Force	STATE-WIDE	34	2024-25 to 2028-29
Court Audio/Visual Maintenance and Enhancements	Justice	STATE-WIDE	30	2013-14 to 2028-29
Kimberley District Support Facility	Western Australia Police Force	KIMBERLEY	30	2023-24 to 2027-28
Forrestfield Police Station	Western Australia Police Force	PERTH METRO	27	2021-22 to 2025-26
Baldivis Police Station	Western Australia Police Force	PERTH METRO	27	2021-22 to 2025-26
VFRS/VFES Upgrade and Replacement Program	Fire and Emergency Services	STATE-WIDE	26	2018-19 to 2028-29

Transport and Major Infrastructure

Project name	Responsible organisation	Region	Estimated Total Cost (\$m)	Entire Project Period
Major Projects - High-Capacity Signalling - Program of Works	Public Transport Authority	PERTH METRO	3,006	2015-16 to 2033-2034
Tonkin Highway Gap; Grade Separations at Hale, Welshpool and Kelvin Roads; and Stage Three Extension	Commissioner of Main Roads	PERTH METRO	1,882	2017-18 to 2028-29

Project name	Responsible organisation	Region	Estimated Total Cost (\$m)	Entire Project Period
METRONET - Forrestfield-Airport Link	Public Transport Authority	PERTH METRO	1,841	2013-14 to 2025-26
METRONET - Morley-Ellenbrook Line	Public Transport Authority	PERTH METRO	1,667	2020-21 to 2025-26
METRONET - Thornlie-Cockburn Link	Public Transport Authority	PERTH METRO	1,627	2017-18 to 2025-26
Social Housing - Investment into New Social Housing	Housing and Works	STATE-WIDE	1,563	2020-21 to 2028-29
METRONET - Level Crossing Removal - Victoria Park-Canning	Public Transport Authority	PERTH METRO	1,547	2020-21 to 2025-26
Bunbury Outer Ring Road	Commissioner of Main Roads	SOUTH WEST	1,465	2017-18 to 2025-26
METRONET - Yanchep Rail Extension	Public Transport Authority	PERTH METRO	1,343	2017-18 to 2025-26
METRONET - Byford Rail Extension	Public Transport Authority	PEEL	1,335	2021-22 to 2025-26
Capitalisation of Reseal Program	Commissioner of Main Roads	STATE-WIDE	1,078	2015-16 to 2028-29
Regional Road Safety Program	Commissioner of Main Roads	REGIONAL - ALL	964	2020-21 to 2026-27
Railcar Program - Railcar Replacement	Public Transport Authority	PERTH METRO	945	2018-19 to 2029-30
Rail Infrastructure Program - Rail Infrastructure	Public Transport Authority	STATE-WIDE	924	2019-20 to 2029-30
Southern Suburbs Roads - Kwinana Freeway Widening	Commissioner of Main Roads	PERTH METRO	700	2026-27 to 2029-30
Safer Roads and Bridges Program	Commissioner of Main Roads	STATE-WIDE	636	2008-09 to 2028-29

Project name	Responsible organisation	Region	Estimated Total Cost (\$m)	Entire Project Period
Port of Port Hedland - Lumsden Point General Cargo Facility and Logistics Hub	Pilbara Ports Authority	PILBARA	629	2022-23 to 2026-27
Railcar Program - Railcar Acquisition	Public Transport Authority	PERTH METRO	511	2017-18 to 2029-30
Northern Suburbs Roads - Reid Highway and Erindale Road Grade Separation	Commissioner of Main Roads	PERTH METRO	450	2025-26 to 2029-30
Government Regional Officer Housing	Housing and Works	REGIONAL - ALL	438	2020-21 to 2028-29
Bus Electrification	Public Transport Authority	PERTH METRO	435	2023-24 to 2028-29
Queen Victoria Street - Swan River Crossings (Fremantle Road and Rail Bridge) - Construct New Bridge	Commissioner of Main Roads	PERTH METRO	430	2019-20 to 2026-27
Land - Acquisition Program	Housing and Works	STATE-WIDE	419	2020-21 to 2028-29
METRONET - New Midland Station Delivery	Public Transport Authority	PERTH METRO	417	2021-22 to 2026-27
Karratha to Tom Price - Manuwarra Red Dog Highway	Commissioner of Main Roads	PILBARA	380	2017-18 to 2026-27
Port Maximisation Project	Mid West Ports Authority	MID WEST	350	2021-22 to 2028-29
Port of Dampier - Dampier Bulk Handling Facility	Pilbara Ports Authority	PILBARA	298	2022-23 to 2025-26

Project name	Responsible organisation	Region	Estimated Total Cost (\$m)	Entire Project Period
Thomas Road - Southwestern Highway to Tonkin Highway Dual Carriageway	Commissioner of Main Roads	PEEL	290	2021-22 to 2029-30
Mitchell Freeway - Stephenson Avenue	Commissioner of Main Roads	PERTH METRO	288	2020-21 to 2025-26
Smart Freeways - Hodges Drive to Hepburn Avenue Widening Southbound	Commissioner of Main Roads	PERTH METRO	276	2016-17 to 2025-26
Great Northern Highway - Bindoon Bypass - Construct New Alignment	Commissioner of Main Roads	WHEATBELT	275	2020-21 to 2029-30
Major Projects - Future Urban Railcar Procurement	Public Transport Authority	STATE-WIDE	261	2015-16 to 2025-26
Great Eastern Highway - Coates Gully, Walgoolan to Southern Cross and Ghooli to Benari	Commissioner of Main Roads	WHEATBELT	250	2020-21 to 2027-28
Pinjarra Heavy Haulage Deviation - Stage One and Stage Two	Commissioner of Main Roads	PEEL	250	2017-18 to 2029-30
Thomas and Anketell Roads Freight Upgrade - Stages One and Two Planning	Commissioner of Main Roads	PEEL	241	2020-21 to 2025-26
Port of Port Hedland - Hedland Maritime Initiative	Pilbara Ports Authority	PILBARA	236	2020-21 to 2026-27

Project name	Responsible organisation	Region	Estimated Total Cost (\$m)	Entire Project Period
Reid Highway - Altone Road and Daviot Road/Drumpellier Drive Grade Separations	Commissioner of Main Roads	PERTH METRO	225	2021-22 to 2027-28
Shared Equity Purchase Program	Housing and Works	STATE-WIDE	219	2020-21 to 2028-29
Perth Entertainment and Sporting Precinct	Commissioner of Main Roads	PERTH METRO	218	2024-25 to 2026-27
Road Safety Commission - Regional Road Safety Improvements	Commissioner of Main Roads	REGIONAL - ALL	209	2013-14 to 2027-28
Fiona Stanley Precinct - Carparks	Commissioner of Main Roads	PERTH METRO	204	2024-25 to 2028-29
Canning Bridge Bus Interchange	Commissioner of Main Roads	PERTH METRO	200	2023-24 to 2029-30
Projects Under Development	METRONET Projects Under Development	STATE-WIDE	195	2026-27 to 2028-29
Roe Highway - Great Eastern Highway Bypass Including Abernethy Road	Commissioner of Main Roads	PERTH METRO	180	2017-18 to 2026-27
Freight Program - Western Australian Agricultural Supply Chain Improvements	Public Transport Authority	WHEATBELT	177	2022-23 to 2027-28
Reid Highway - West Swan and Reid Highway Interchange	Commissioner of Main Roads	PERTH METRO	175	2020-21 to 2029-30

Project name	Responsible organisation	Region	Estimated Total Cost (\$m)	Entire Project Period
Major Projects - Stirling Bus Interchange	Public Transport Authority	PERTH METRO	174	2021-22 to 2025-26
Bussell Highway Duplication Stage One and Stage Two	Commissioner of Main Roads	SOUTH WEST	170	2020-21 to 2025-26
Railcar Program - Australind Railcar Replacement	Public Transport Authority	STATE-WIDE	162	2017-18 to 2026-27
Derby - Gibb River - Wyndham - Improve Formation and Gravel	Commissioner of Main Roads	KIMBERLEY	160	2012-13 to 2028-29
Principal Shared Path Program	Commissioner of Main Roads	PERTH METRO	160	2014-15 to 2028-29
Social Housing - Social Housing Accelerator	Housing and Works	STATE-WIDE	154	2023-24 to 2027-28
METRONET Social and Affordable Housing and Jobs Package	Housing and Works	PERTH METRO	152	2018-19 to 2027-28
Mandurah Estuary Bridge Duplication	Commissioner of Main Roads	PEEL	149	2021-22 to 2026-27
Nicholson Road and Garden Street Grade Separation Planning and Construction	Commissioner of Main Roads	PERTH METRO	145	2022-23 to 2029-30
Rail Infrastructure Program - Rail Revitalisation Program	Public Transport Authority	PERTH METRO	142	2022-23 to 2025-26

Project name	Responsible organisation	Region	Estimated Total Cost (\$m)	Entire Project Period
Westport - Westport Marine and Port Infrastructure	Transport	PERTH METRO	136	2024-25 to 2028-29
Road Safety Commission - Metropolitan Intersections Crash Program	Commissioner of Main Roads	PERTH METRO	131	2013-14 to 2028-29
All Southern Ports - Sustaining Capital Works	Southern Ports Authority	REGIONAL - ALL	121	2022-23 to 2028-29
Maritime - Transforming Bunbury's Waterfront - Stage Three	Transport	SOUTH WEST	112	2021-22 to 2026-27
All Pilbara Ports - Sustaining Capital Works	Pilbara Ports Authority	PILBARA	112	2024-25 to 2028-29
Brooking Channel Bridge Replacement	Commissioner of Main Roads	KIMBERLEY	107	2023-24 to 2025-26
METRONET on Swan	Public Transport Authority	PERTH METRO	107	2024-25 to 2027-28
Operational Business Support Systems Program - Business Support Upgrades	Public Transport Authority	STATE-WIDE	106	2017-18 to 2029-30
Other - Affordable Rental Build Program	Housing and Works	STATE-WIDE	105	2024-25 to 2027-28
Tonkin Highway Corridor Upgrades - North Ellenbrook Interchange	Commissioner of Main Roads	PERTH METRO	100	2022-23 to 2026-27
Road Safety Commission - School Zone and Crossing Program	Commissioner of Main Roads	PERTH METRO	94	2011-12 to 2028-29

Project name	Responsible organisation	Region	Estimated Total Cost (\$m)	Entire Project Period
Housing and Homelessness Investment Package - Common Ground - Perth	Housing and Works	PERTH METRO	89	2020-21 to 2026-27
Inner and Outer Harbour - Sustaining Capital Works	Fremantle Port Authority	PERTH METRO	86	2024-25 to 2028-29
Indian Ocean Drive - Jurien Bay to Brand Highway	Commissioner of Main Roads	MID WEST	82	2021-22 to 2025-26
Toodyay Road Upgrade - Dryandra to Toodyay	Commissioner of Main Roads	WHEATBELT	80	2021-22 to 2026-27
Social Housing - Crisis Accommodation Program	Housing and Works	STATE-WIDE	76	2020-21 to 2028-29
Port of Dampier - Dampier Link Bridge	Pilbara Ports Authority	PILBARA	75	2025-26 to 2026-27
METRONET - Lakelands Station	Public Transport Authority	PEEL	72	2018-19 to 2025-26
Operational Business Support Systems Program - Parking Facilities Upgrades	Public Transport Authority	STATE-WIDE	72	2021-22 to 2028-29
Great Northern Highway - Newman to Port Hedland Overtaking Lanes	Commissioner of Main Roads	PILBARA	65	2021-22 to 2025-26
Inner Harbour - Inner Harbour - Infrastructure Refurbishment Program Stage 2	Fremantle Port Authority	PERTH METRO	65	2025-26 to 2028-29

Project name	Responsible organisation	Region	Estimated Total Cost (\$m)	Entire Project Period
Outer Harbour - Kwinana Bulk Jetty - Deck Soffit and Impressed Current Cathodic Protection System Replacement	Fremantle Port Authority	PERTH METRO	61	2024-25 to 2029-30
Bus Infrastructure Program - Smartrider System Asset Replacement and Technology Update	Public Transport Authority	STATE-WIDE	60	2017-18 to 2025-26
Great Northern Highway - Marble Bar Road Upgrade	Commissioner of Main Roads	PILBARA	60	2021-22 to 2025-26
Great Northern Highway - Nellie Springs to Sally Downs Well and Arthur Creek	Commissioner of Main Roads	KIMBERLEY	60	2021-22 to 2027-28
Menang Drive and Chester Pass Road - Grade Separation	Commissioner of Main Roads	GREAT SOUTHERN	60	2023-24 to 2026-27
Westport - Environmental Offsets Land Acquisitions - Anketell Road	Commissioner of Main Roads	STATE-WIDE	54	2024-25 to 2025-26
Social Housing Economic Recovery Package - New Builds	Housing and Works	STATE-WIDE	53	2020-21 to 2025-26
Sustaining Capital Works	Mid West Ports Authority	MID WEST	53	2024-25 to 2028-29
METRONET - New Midland Station Multi-Storey Car Park	Public Transport Authority	PERTH METRO	51	2022-23 to 2025-26

Project name	Responsible organisation	Region	Estimated Total Cost (\$m)	Entire Project Period
Freight Vehicle Productivity Improvements Program	Commissioner of Main Roads	STATE-WIDE	50	2020-21 to 2025-26
Social Housing - Regional Supportive Landlord Model	Housing and Works	MID WEST	50	2023-24 to 2026-27
Housing and Homelessness Investment Package - Common Grounds - Mandurah	Housing and Works	PEEL	49	2020-21 to 2026-27
Land - Joint Ventures	Housing and Works	STATE-WIDE	47	2021-22 to 2028-29
Rail Crossing Program	Commissioner of Main Roads	STATE-WIDE	45	2020-21 to 2028-29
Operational Business Support Systems Program - CCTV Program	Public Transport Authority	STATE-WIDE	40	2019-20 to 2029-30
Port of Dampier - Dampier Cargo Wharf Refurbishment	Pilbara Ports Authority	PILBARA	40	2027-28 to 2027-28
Maritime - Ocean Reef Marina - Essential Operational Infrastructure	Transport	PERTH METRO	39	2024-25 to 2027-28
Congdon Street Bridge Replacement	Commissioner of Main Roads	PERTH METRO	38	2023-24 to 2026-27
Rail Stations Program - New Stations and Existing Stations Upgrades	Public Transport Authority	PERTH METRO	38	2017-18 to 2025-26
Port of Port Hedland - Utah Ring Road Reconstruction	Pilbara Ports Authority	PILBARA	37	2024-25 to 2027-28

Project name	Responsible organisation	Region	Estimated Total Cost (\$m)	Entire Project Period
Maritime - Broome Boating Initiative	Transport	KIMBERLEY	36	2025-26 to 2028-29
Inner Harbour - Inner Harbour Refurbishment Program Stage 1	Fremantle Port Authority	PERTH METRO	36	2022-23 to 2029-30
Northern Suburbs Roads - Wanneroo Intersection Upgrades and Whitfords Avenue to Gnangara Road Planning	Commissioner of Main Roads	PERTH METRO	36	2025-26 to 2028-29
Inner Harbour - Berths F & G Fenders/Deck Strengthening	Fremantle Port Authority	PERTH METRO	36	2025-26 to 2029-30
Outer Harbour - Infrastructure, Equipment Replacement and Upgrade	Fremantle Port Authority	PERTH METRO	35	2010-11 to 2026-27
Wanneroo Road Duplication - Dunstan Road to Romeo Road	Commissioner of Main Roads	PERTH METRO	35	2021-22 to 2025-26
Buildings and Equipment - 2027-28 Program	Commissioner of Main Roads	STATE-WIDE	35	2027-28 to 2027-28
Port of Bunbury - Inner Harbour Access Bridge	Southern Ports Authority	SOUTH WEST	34	2020-21 to 2025-26
Buildings and Equipment - 2026-27 Program	Commissioner of Main Roads	STATE-WIDE	34	2026-27 to 2026-27
Regional Level Crossing Upgrade	Commissioner of Main Roads	REGIONAL - ALL	34	2023-24 to 2026-27

Project name	Responsible organisation	Region	Estimated Total Cost (\$m)	Entire Project Period
Port of Ashburton - Port Infrastructure Construction Project	Pilbara Ports Authority	PILBARA	32	2013-14 to 2026-27
Buildings and Equipment - 2028-29 Program	Commissioner of Main Roads	STATE-WIDE	31	2028-29 to 2028-29
Inner Harbour - B-Shed Revitalisation	Fremantle Port Authority	PERTH METRO	30	2025-26 to 2027-28
Regional Black Spot Program	Commissioner of Main Roads	REGIONAL - ALL	29	2021-22 to 2025-26
Major Projects - Westport Projects	Public Transport Authority	PERTH METRO	29	2024-25 to 2028-29
Aboriginal Short Stay Accommodation - Geraldton	Housing and Works	MID WEST	28	2020-21 to 2025-26
Inner and Outer Harbour - Bollard Replacement & Refurbishment Program	Fremantle Port Authority	PERTH METRO	27	2024-25 to 2027-28
Minor Works (includes Black Spot and Urgent Minor Works) - 2026-27 Program	Commissioner of Main Roads	STATE-WIDE	27	2026-27 to 2026-27
Minor Works (includes Black Spot and Urgent Minor Works) - 2027-28 Program	Commissioner of Main Roads	STATE-WIDE	27	2027-28 to 2027-28
Minor Works (includes Black Spot and Urgent Minor Works) - 2028-29 Program	Commissioner of Main Roads	STATE-WIDE	27	2028-29 to 2028-29

Project name	Responsible organisation	Region	Estimated Total Cost (\$m)	Entire Project Period
Port-Wide Firefighting System	Mid West Ports Authority	MID WEST	27	2021-22 to 2027-28
Aboriginal Short Stay Accommodation - Perth	Housing and Works	PERTH METRO	26	2021-22 to 2027-28
Buildings and Equipment - 2025-26 Program	Commissioner of Main Roads	STATE-WIDE	26	2025-26 to 2025-26
Minor Works (includes Black Spot and Urgent Minor Works) - 2025-26 Program	Commissioner of Main Roads	STATE-WIDE	25	2025-26 to 2025-26
Murdoch Health and Knowledge Precinct Transport Improvements	Commissioner of Main Roads	PERTH METRO	25	2024-25 to 2026-27
METRONET - Caledonian Avenue Level Crossing Closure	Commissioner of Main Roads	PERTH METRO	25	2020-21 to 2025-26
Northam Pithara Road - Realignment and Bridge Replacements	Commissioner of Main Roads	WHEATBELT	25	2025-26 to 2026-27
South Coast Highway - Kojaneerup and Shannon	Commissioner of Main Roads	GREAT SOUTHERN	25	2026-27 to 2028-29
Heavy Vehicle Safety and Productivity Program - Commonwealth Government	Commissioner of Main Roads	STATE-WIDE	25	2020-21 to 2025-26
Outer Harbour - Kwinana Bulk Berth 2 - Refurbishment of Critical Trade Infrastructure - Stage 2	Fremantle Port Authority	PERTH METRO	25	2024-25 to 2029-30

Project name	Responsible organisation	Region	Estimated Total Cost (\$m)	Entire Project Period
Bus Infrastructure Program - BRE and LXR Buses and Depot	Public Transport Authority	PEEL	24	2024-25 to 2026-27
Port of Dampier - Perdaman and Dampier Bulk Handling Facility Related Projects	Pilbara Ports Authority	PILBARA	23	2024-25 to 2025-26
Social Housing - Crisis Accommodation Program (CAP) - Stirling Women's Refuge	Housing and Works	PERTH METRO	23	2023-24 to 2028-29
Freight Program - Grain Freight Upgrades	Public Transport Authority	REGIONAL - ALL	22	2022-23 to 2025-26
Westport - Anketell Road Definition	Commissioner of Main Roads	PERTH METRO	22	2024-25 to 2027-28
Major Port Infrastructure - Wharf Facility Works - Port of Broome	Kimberley Ports Authority	KIMBERLEY	22	2023-24 to 2025-26
Westport - Kwinana Bulk Terminal Replacement	Transport	PERTH METRO	22	2024-25 to 2028-29
Aboriginal Short Stay Accommodation - East Kimberley	Housing and Works	KIMBERLEY	21	2021-22 to 2028-29
Sustaining Capital Allocation - Sustaining Capital Works	Kimberley Ports Authority	KIMBERLEY	21	2024-25 to 2028-29
Victoria Quay - J Berth Refurbishment	Fremantle Port Authority	PERTH METRO	20	2025-26 to 2027-28

Project name	Responsible organisation	Region	Estimated Total Cost (\$m)	Entire Project Period
Forrest Highway (Vittoria Road) - New Intersection and Road Connection	Commissioner of Main Roads	SOUTH WEST	20	2022-23 to 2026-27
Orrong Road Upgrade - Graham Farmer Freeway to Leach Highway Planning	Commissioner of Main Roads	PERTH METRO	20	2020-21 to 2025-26
Port of Port Hedland - Inner Harbour Revetment Upgrades	Pilbara Ports Authority	PILBARA	20	2020-21 to 2025-26

Environment

Project name	Responsible organisation	Region	Estimated Total Cost (\$m)	Entire Project Period
Rottnest Island Authority - Workers Accommodation	Biodiversity, Conservation and Attractions	PERTH METRO	98	2024-25 to 2030-31
Rottnest Island Authority - Electrical Infrastructure Upgrade	Biodiversity, Conservation and Attractions	PERTH METRO	91	2022-23 to 2028-29
Rottnest Island Authority - Infrastructure Stimulus Package - Water Production	Biodiversity, Conservation and Attractions	PERTH METRO	68	2020-21 to 2028-29

Project name	Responsible organisation	Region	Estimated Total Cost (\$m)	Entire Project Period
Perth Zoo Master Plan 2040	Biodiversity, Conservation and Attractions	PERTH METRO	40	2021-22 to 2027-28
State Groundwater Investigation Program	Water and Environmental Regulation	STATE-WIDE	37	2019-20 to 2028-29
Environment Online	Water and Environmental Regulation	STATE-WIDE	36	2020-21 to 2025-26
Replace and Maintain Monitoring Bores	Water and Environmental Regulation	STATE-WIDE	35	2019-20 to 2028-29
Rottnest Island Authority - Marine Logistics Hub (Barge Landing Army Groyne)	Biodiversity, Conservation and Attractions	PERTH METRO	32	2024-25 to 2027-28
Tourism Package - Peri-Urban Parks	Biodiversity, Conservation and Attractions	PERTH METRO	29	2021-22 to 2025-26
Rottnest Island Authority - Main Jetty	Biodiversity, Conservation and Attractions	PERTH METRO	24	2020-21 to 2025-26
Karijini National Park Upgrades	Biodiversity, Conservation and Attractions	PILBARA	21	2021-22 to 2025-26
Plan for Our Parks - Mount Augustus National Park	Biodiversity, Conservation and Attractions	GASCOYNE	21	2023-24 to 2028-29

Planning and Land Use

Project name	Responsible organisation	Region	Estimated Total Cost (\$m)	Entire Project Period
Development of Land - Industry and Infrastructure Acquisition and Development	Western Australian Land Authority (DevelopmentWA)	STATE-WIDE	2,093	2008-09 to 2028-29
Development of Land - Regional Land Acquisition and Development	Western Australian Land Authority (DevelopmentWA)	REGIONAL - ALL	1,745	2006-07 to 2028-29
Development of Land - Metropolitan Land Acquisition and Development	Western Australian Land Authority (DevelopmentWA)	PERTH METRO	1,674	2014-15 to 2028-29
Development of Land - Residential Projects and Land Development for Social and Affordable Housing	Western Australian Land Authority (DevelopmentWA)	PERTH METRO	942	2020-21 to 2028-29
Development of Land - Housing Australia Future Fund Projects	Western Australian Land Authority (DevelopmentWA)	PERTH METRO	288	2024-25 to 2027-28
Development of Land - Ocean Reef Marina	Western Australian Land Authority (DevelopmentWA)	PERTH METRO	270	2017-18 to 2028-29

Project name	Responsible organisation	Region	Estimated Total Cost (\$m)	Entire Project Period
Development of Land - Alkimos Central	Western Australian Land Authority (DevelopmentWA)	PERTH METRO	177	2019-20 to 2028-29
Development of Land - Pier Street Residential Development	Western Australian Land Authority (DevelopmentWA)	PERTH METRO	154	2022-23 to 2026-27
Development of Land - Industrial Lands Authority Program - Western Trade Coast	Western Australian Land Authority (DevelopmentWA)	PERTH METRO	152	2025-26 to 2025-26
Development of Land - Subi East Precinct	Western Australian Land Authority (DevelopmentWA)	PERTH METRO	146	2019-20 to 2028-29
Development of Land - Fremantle Burt Street Residential Development	Western Australian Land Authority (DevelopmentWA)	PERTH METRO	121	2023-24 to 2027-28
Development of Land - East Perth Power Station	Western Australian Land Authority (DevelopmentWA)	PERTH METRO	93	2019-20 to 2025-26
Development of Land - Karratha Madigan Road	Western Australian Land Authority (DevelopmentWA)	PILBARA	66	2023-24 to 2027-28
Development of Land - Peel Business Park, Nambeelup	Western Australian Land Authority (DevelopmentWA)	PEEL	48	2016-17 to 2025-26

Project name	Responsible organisation	Region	Estimated Total Cost (\$m)	Entire Project Period
Development of Land - Bentley Residential Redevelopment	Western Australian Land Authority (DevelopmentWA)	PERTH METRO	44	2022-23 to 2028-29
Development of Land - Karratha Mulataga	Western Australian Land Authority (DevelopmentWA)	PILBARA	43	2024-25 to 2028-29
Acquisition of Land - 2025-26 Program	WA Planning Commission	PERTH METRO	40	2025-26 to 2025-26
Acquisition of Land - 2026-27 Program	WA Planning Commission	PERTH METRO	40	2026-27 to 2026-27
Acquisition of Land - 2027-28 Program	WA Planning Commission	PERTH METRO	40	2027-28 to 2027-28
Acquisition of Land - 2028-29 Program	WA Planning Commission	PERTH METRO	40	2028-29 to 2028-29
Buildings/Infrastructure	WA Planning Commission	PERTH METRO	25	2004-05 to 2028-29
Development of Land - Neerabup Australian Automation and Robotics Park	Western Australian Land Authority (DevelopmentWA)	PERTH METRO	25	2020-21 to 2028-29

Water

Project name	Responsible organisation	Region	Estimated Total Cost (\$m)	Entire Project Period
Metropolitan - Supply Capacity	Water Corporation	PERTH METRO	3,252	2018-19 to 2028-29
Metropolitan - Treatment Capacity	Water Corporation	PERTH METRO	948	2018-19 to 2028-29
Regional - Water - Network Renewals	Water Corporation	STATE-WIDE	905	2018-19 to 2028-29
Metropolitan - Wastewater - Network Capacity	Water Corporation	PERTH METRO	728	2018-19 to 2028-29
Regional - Supply Capacity	Water Corporation	STATE-WIDE	713	2018-19 to 2028-29
Metropolitan - Water - Network Capacity	Water Corporation	PERTH METRO	519	2018-19 to 2028-29
Service - Business Support Costs	Water Corporation	STATE-WIDE	515	2018-19 to 2028-29
Metropolitan - Water - Network Renewals	Water Corporation	PERTH METRO	502	2018-19 to 2028-29
Regional - Water - Network Capacity	Water Corporation	STATE-WIDE	402	2018-19 to 2028-29
Service - Energy Infrastructure	Water Corporation	STATE-WIDE	322	2022-23 to 2027-28
Service - Capital Support Costs	Water Corporation	STATE-WIDE	313	2018-19 to 2028-29
Relocation and Augmentation of Network Assets	Water Corporation	PERTH METRO	298	2021-22 to 2025-26
Regional - Treatment Capacity	Water Corporation	STATE-WIDE	295	2018-19 to 2028-29

Project name	Responsible organisation	Region	Estimated Total Cost (\$m)	Entire Project Period
Service - Operational Information and Control	Water Corporation	STATE-WIDE	292	2018-19 to 2028-29
Metropolitan - Wastewater - Network Renewals	Water Corporation	PERTH METRO	236	2018-19 to 2028-29
Service - Corporate Real Estate	Water Corporation	STATE-WIDE	216	2018-19 to 2028-29
Regional - Wastewater - Network Renewals	Water Corporation	STATE-WIDE	156	2018-19 to 2028-29
Metropolitan - Treatment Renewals	Water Corporation	PERTH METRO	150	2018-19 to 2028-29
Regional - Irrigation	Water Corporation	STATE-WIDE	141	2018-19 to 2028-29
Regional - Wastewater - Network Capacity	Water Corporation	STATE-WIDE	124	2018-19 to 2028-29
Regional - Treatment Renewals	Water Corporation	STATE-WIDE	103	2018-19 to 2028-29
Metropolitan - Capacity	Water Corporation	STATE-WIDE	85	2018-19 to 2028-29
Remote Aboriginal Communities Accelerated Works	Water Corporation	KIMBERLEY	78	2021-22 to 2028-29
Election Commitment - Essential and Municipal Services Upgrade Program	Water Corporation	KIMBERLEY	65	2019-20 to 2028-29
Water Resource Recovery Scheme	Bunbury Water Corporation (Aqwest)	SOUTH WEST	56	2020-21 to 2026-27

Project name	Responsible organisation	Region	Estimated Total Cost (\$m)	Entire Project Period
Treatment Plants - Inland Borefield Transition - New Water Treatment Plant (Plant 8)	Busselton Water Corporation	SOUTH WEST	52	2023-24 to 2028-29
Regional - Capacity	Water Corporation	STATE-WIDE	35	2018-19 to 2028-29

Energy

Project name	Responsible organisation	Region	Estimated Total Cost (\$m)	Entire Project Period
Government Initiatives - Decarbonisation	Western Power (Electricity Networks Corporation)	STATE-WIDE	1,742	2022-23 to 2028-29
Decarbonisation - Collie Battery Energy Storage System 1 (CBESS 1)	Synergy (Electricity Generation and Retail Corporation)	SOUTH WEST	1,630	2022-23 to 2025-26
Decarbonisation - King Rocks Wind Farm	Synergy (Electricity Generation and Retail Corporation)	WHEATBELT	503	2024-25 to 2026-27
Growth - Distribution - Capacity Expansion	Western Power (Electricity Networks Corporation)	STATE-WIDE	487	2014-15 to 2028-29

Project name	Responsible organisation	Region	Estimated Total Cost (\$m)	Entire Project Period
Growth - Transmission - Capacity Expansion	Western Power (Electricity Networks Corporation)	STATE-WIDE	372	2014-15 to 2029-30
Asset Management Plan - Safety	Horizon Power (Regional Power Corporation)	REGIONAL - ALL	242	2010-11 to 2028-29
Customer Funded Works - Other Customer Driven Works	Horizon Power (Regional Power Corporation)	REGIONAL - ALL	183	2010-11 to 2028-29
Asset Management Plan - Asset Replacement	Horizon Power (Regional Power Corporation)	REGIONAL - ALL	179	2013-14 to 2028-29
Generation - Muja Power Station	Synergy (Electricity Generation and Retail Corporation)	SOUTH WEST	175	2013-14 to 2026-27
Generation - Cockburn Gas Turbine	Synergy (Electricity Generation and Retail Corporation)	PERTH METRO	151	2013-14 to 2028-29
Asset Management Plan - Reliability	Horizon Power (Regional Power Corporation)	REGIONAL - ALL	145	2010-11 to 2028-29
Government Initiatives - Relocation and Augmentation of Network Assets	Western Power (Electricity Networks Corporation)	PERTH METRO	134	2021-22 to 2028-29
Generation - Pinjar Gas Turbine	Synergy (Electricity Generation and Retail Corporation)	PERTH METRO	124	2013-14 to 2026-27

Project name	Responsible organisation	Region	Estimated Total Cost (\$m)	Entire Project Period
Generation - Other Generation Infrastructure Projects	Synergy (Electricity Generation and Retail Corporation)	STATE-WIDE	93	2013-14 to 2028-29
Generation - Collie Power Station	Synergy (Electricity Generation and Retail Corporation)	SOUTH WEST	91	2013-14 to 2025-26
Corporate - Business Systems Replacement	Synergy (Electricity Generation and Retail Corporation)	PERTH METRO	89	2014-15 to 2028-29
Major Projects - Remote Communities - Transfer of Essential Services	Horizon Power (Regional Power Corporation)	REGIONAL - ALL	83	2023-24 to 2028-29
Generation - Kwinana Power Station	Synergy (Electricity Generation and Retail Corporation)	PERTH METRO	82	2013-14 to 2026-27
Asset Management Plan - Knowledge and Technology Investment	Horizon Power (Regional Power Corporation)	REGIONAL - ALL	77	2011-12 to 2028-29
Corporate - Property, Plant and Equipment	Synergy (Electricity Generation and Retail Corporation)	STATE-WIDE	34	2013-14 to 2028-29
Commonwealth Initiatives - Community Batteries for Household Solar Program	Western Power (Electricity Networks Corporation)	STATE-WIDE	23	2023-24 to 2026-27