

ENDORSEMENT

This structure plan is prepared under the provisions of the Shire of Denmark
Local Planning Scheme No. 3.

IT IS CERTIFIED THAT THIS STRUCTURE PLAN WAS APPROVED BY RESOLUTION OF THE
WESTERN AUSTRALIAN PLANNING COMMISSION ON:

15 AUGUST 1997

In accordance with Schedule 2, Part 4, Clause 28 (2) and refer to Part 1, 2. (b) of the *Planning and Development (Local Planning Schemes) Regulations 2015*.

Date of Expiry:

19 OCTOBER 2028

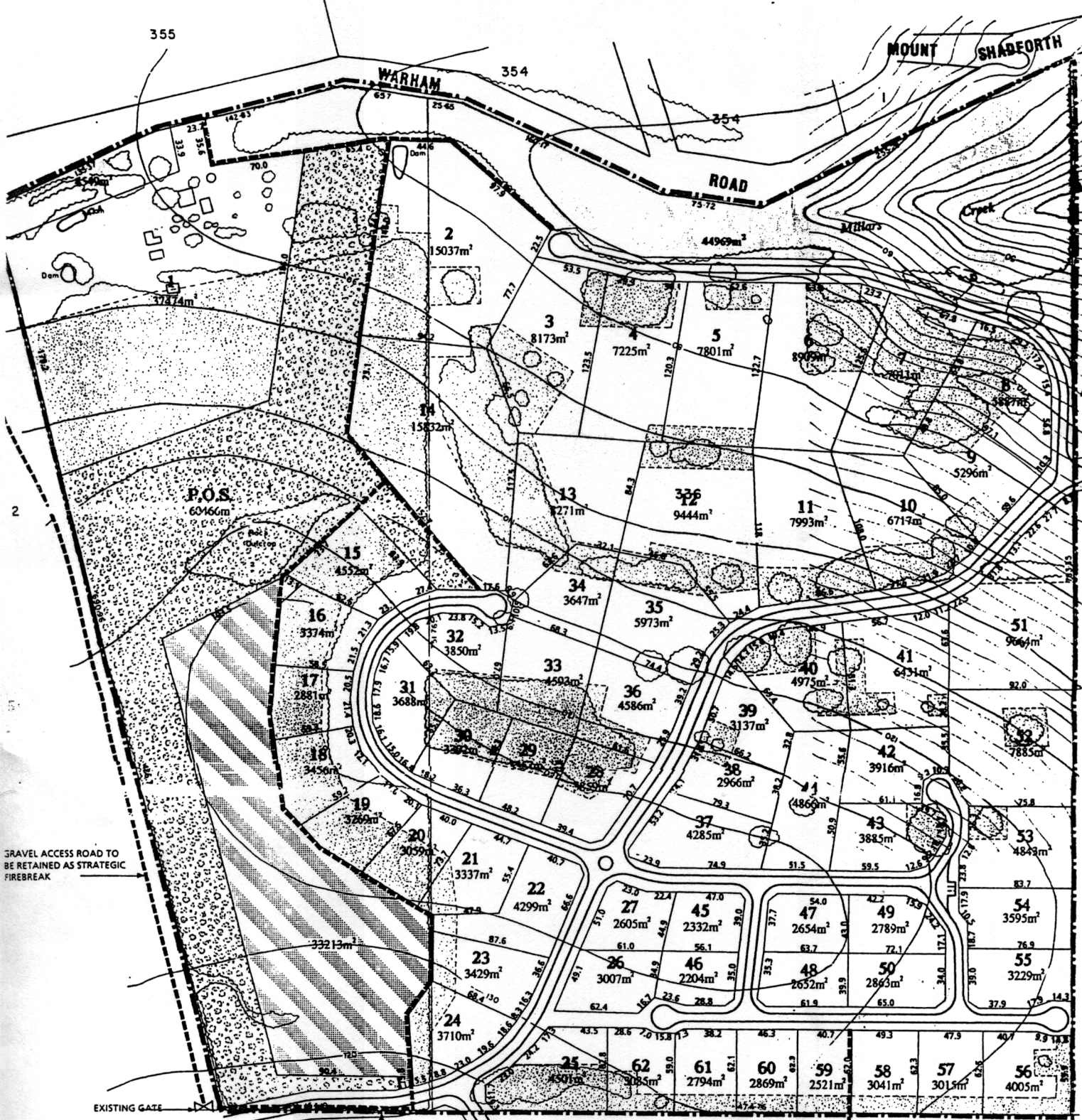

Lots 1-62 Average
Lot Size = 5423m²

- Tree plantation/retention areas
- Forest Common
- Public Open Space
- Foreshore Reserve

- Strategic Firebreak
- Drainage (Nutrient Stripping)

STRATEGIC FIREBREAK BETWEEN THE END OF LOT 24
AND THE EXISTING GATE IN STAGE ONE -
LATER TO BE REPLACED BY FULLY CONSTRUCTED ROAD

Adopted by Resolution of the Council of the Shire of Denmark
at the ... meeting of the Council
held on the ... day of ... 19 ...

SHIRE CLERK
C.F.C.

Application Boundary

1/BDIVISION GUIDE PLAN
LOT 336 & PT. LOT 1 (PT. 339)
WARHAM ROAD, WEST DENMARK

G. ROBERTSON

June 1997 96/50/2



Taylor Bu
Town planning and d
187 Roberts Road Sub
PO Box 932 West Port
Western Australia 62
Telephone (08) 362 2
Facsimile (08) 362 4