

ENDORSEMENT

This structure plan is prepared under the provisions of the Shire of Denmark  
Local Planning Scheme No. 3.

IT IS CERTIFIED THAT THIS STRUCTURE PLAN WAS APPROVED BY RESOLUTION OF THE  
WESTERN AUSTRALIAN PLANNING COMMISSION ON:

29 MARCH 1989

In accordance with Schedule 2, Part 4, Clause 28 (2) and refer to Part 1, 2. (b) of the *Planning and Development (Local Planning Schemes) Regulations 2015*.

Date of Expiry:

19 OCTOBER 2028

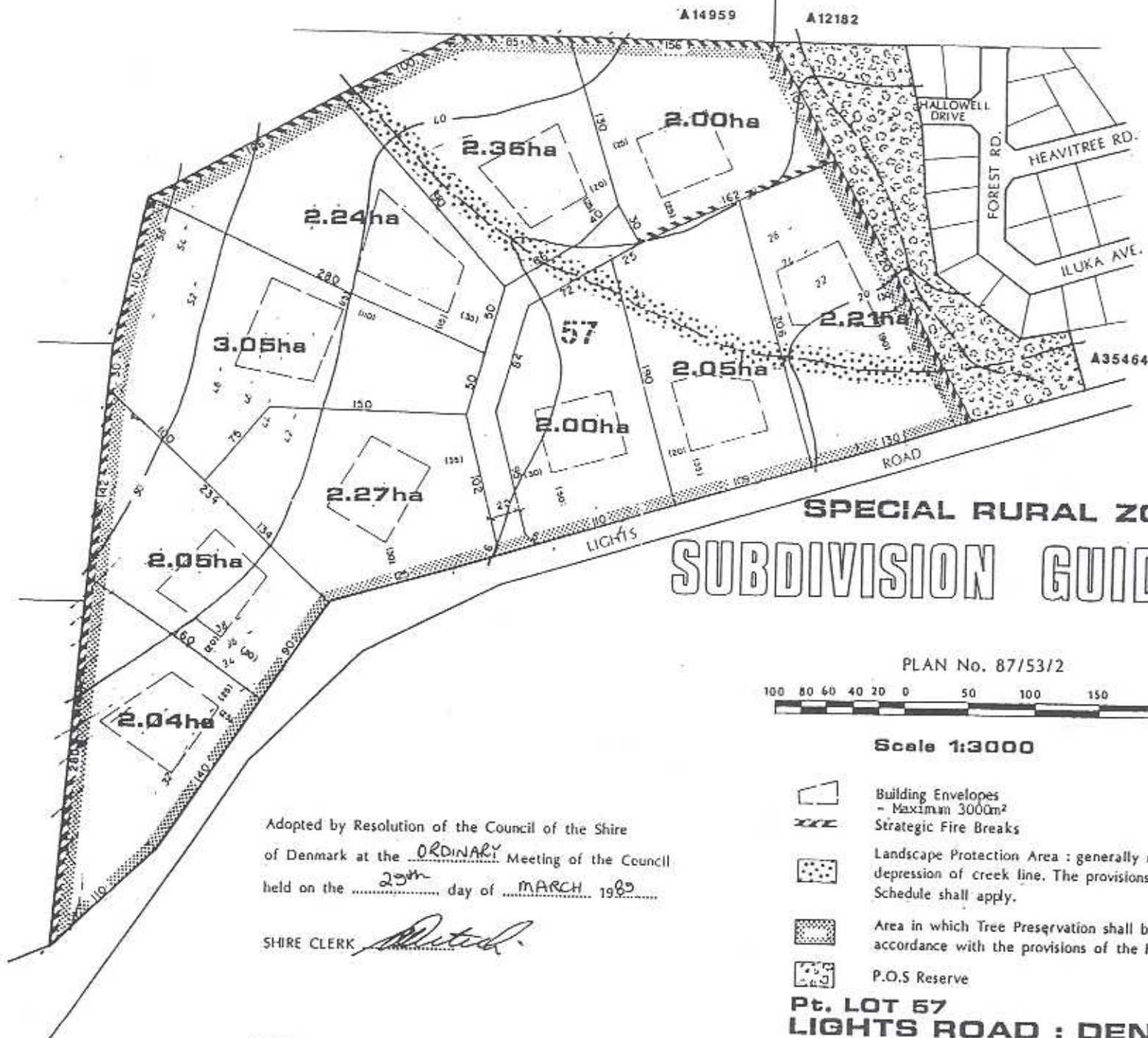

Adopted by Resolution of the Council of the Shire  
of Denmark at the ORDINARY Meeting of the Council  
held on the 29th day of MARCH 1989

SHIRE CLERK *[Signature]*