

ENDORSEMENT PAGE

This structure plan is prepared under the provisions of the Shire of Denmark Local Planning Scheme No. 3.

IT IS CERTIFIED THAT THIS STRUCTURE PLAN WAS APPROVED BY RESOLUTION OF THE WESTERN AUSTRALIAN PLANNING COMMISSION ON:

11 NOVEMBER 2004

In accordance with Schedule 2, Part 4, Clause 28 (2) and refer to Part 1, 2. (b) of the *Planning and Development (Local Planning Schemes) Regulations 2015*.

Date of Expiry:

19 OCTOBER 2028

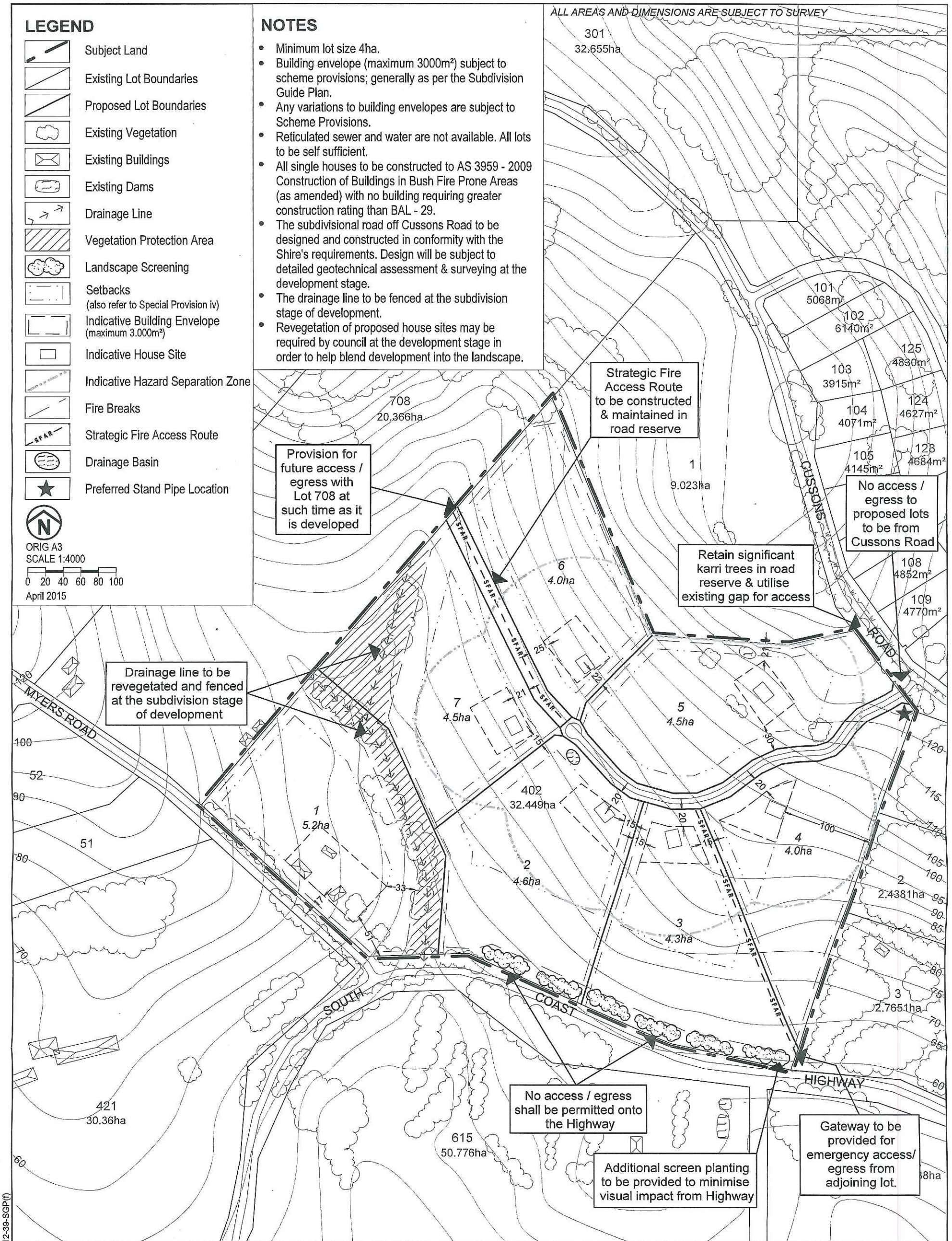

AYTON BAESJOU
PLANNING
11 Duke Street
Albany WA 6330
Ph 9842 2304 Fax 9842 8494

ADOPTED BY RESOLUTION OF THE COUNCIL OF THE
Shire OF Denmark
AT THE Ordinary COUNCIL MEETING
ON THE 11 DAY OF November 2014
CHIEF EXECUTIVE OFFICER 

SUBDIVISION GUIDE PLAN
Lot 402 Myers Road
Shadforth