

Endorsement Page

This structure plan is prepared under the provisions of the Shire of Plantagenet Local Planning Scheme No. 5

IT IS CERTIFIED THAT THIS STRUCTURE PLAN WAS APPROVED BY RESOLUTION OF THE
WESTERN AUSTRALIAN PLANNING COMMISSION ON:

23 March 2010

In accordance with Schedule 2, Part 4, Clause 28 (2) and refer to Part 1, 2. (b) of the Planning and Development (Local Planning Schemes) Regulations 2015.

Date of Expiry:

19 October 2027

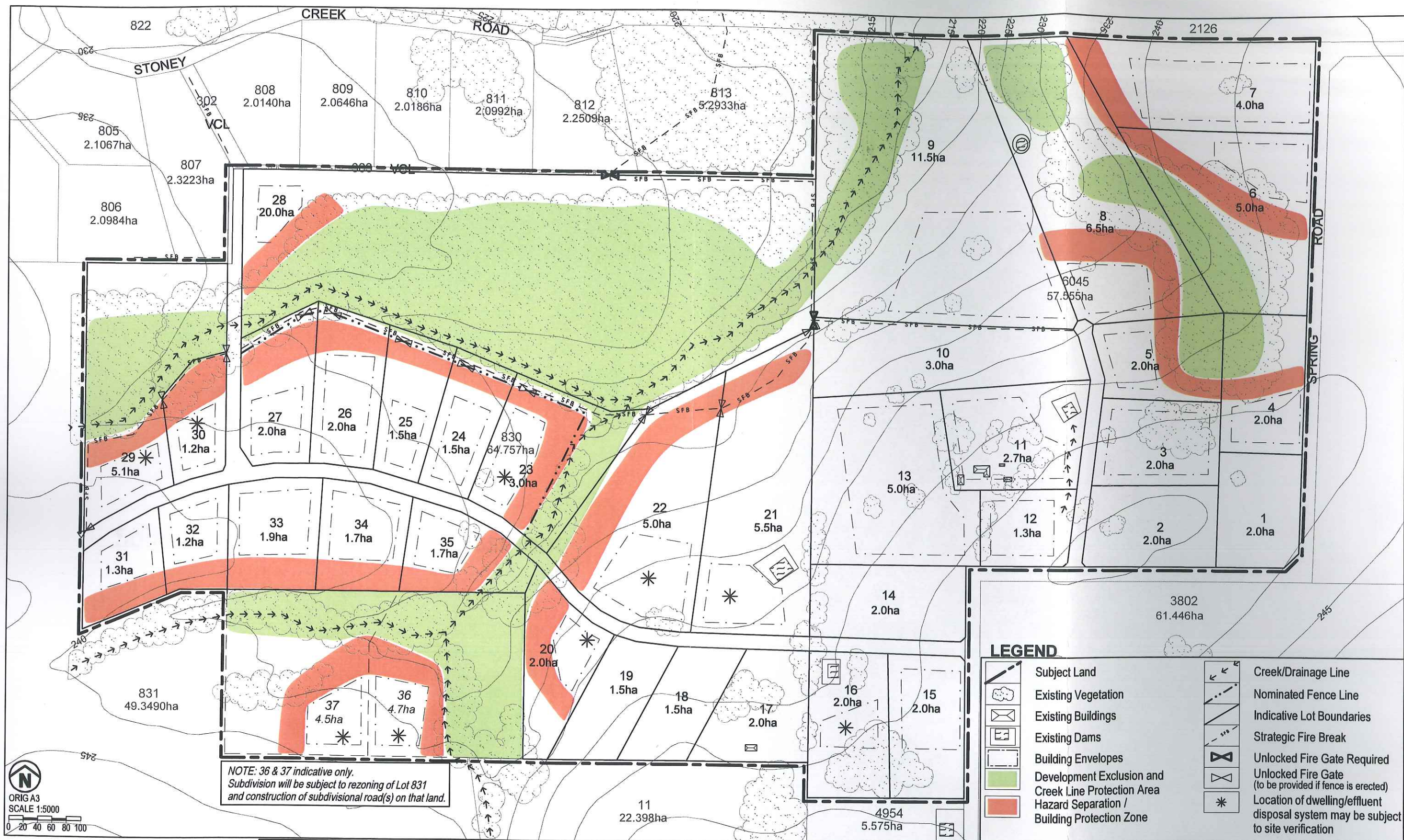

ORIG A3
SCALE 1:5000
0 20 40 60 80 100

AYTON BAESJOU
PLANNING
11 Duke Street
Albany WA 6330
Ph 9842 2304 Fax 9842 8494

ADOPTED BY RESOLUTION OF THE COUNCIL OF THE
SHIRE OF PLANTAGENET
AT THE ORDINARY COUNCIL MEETING
ON THE 23RD DAY OF MARCH 2010
CHIEF EXECUTIVE OFFICER R. [Signature]

NOTE

Habitable Buildings shall be located such the establishment and maintenance of HSZ or BPZ does not encroach on the Creekline Protection or Development Exclusion Areas shown on the SGP. Where a 100 metre HSZ cannot be achieved between habitable buildings and areas of extreme fire hazard, construction shall be in accordance with the requirements of AS3959 for the assessed Bushfire Hazard Level.

SUBDIVISION GUIDE PLAN

Lots 830, 6045 & Pt 831 Spring Road
Porongurup, Shire of Plantagenet

09-13-SGP(f) OCTOBER 10